

Brand New!

Water views!

**National Harbor
174 Waterfront Street
Oxon Hill, MD 20745**

Space Profile

Premises	7,334 RSF on the 3rd floor
Term	Through April 30, 2025
Occupancy	Immediately
Rental Rate	\$28.50/RSF, Full Service
Parking	Right to 28 spaces at market rates

Features

- Gorgeous, brand new finishes throughout
- Water views
- Mix of offices and workstations
- Mostly furnished

For More Information

Cresa
2 Bethesda Metro Center
Suite 900
Bethesda, MD 20814
cresa.com/washingtondc



Josh Freedenberg
301.538.0939
jfreedenberg@cresa.com



Lucia Hedke, LEED GA
202.294.5359
lucia.hedke@jll.com



Sublease Available

*Only occupied for 6 weeks before COVID

Even though obtained from sources deemed reliable, no warranty or representation, express or implied, is made as to the accuracy of the information herein, and it is subject to errors, omissions, change of price, rental or other conditions, withdrawal without notice, and to any special listing conditions imposed by our principals.

cresa



National Harbor
174 Waterfront Street
Oxon Hill, MD 20745

3rd Floor - 7,334 SF

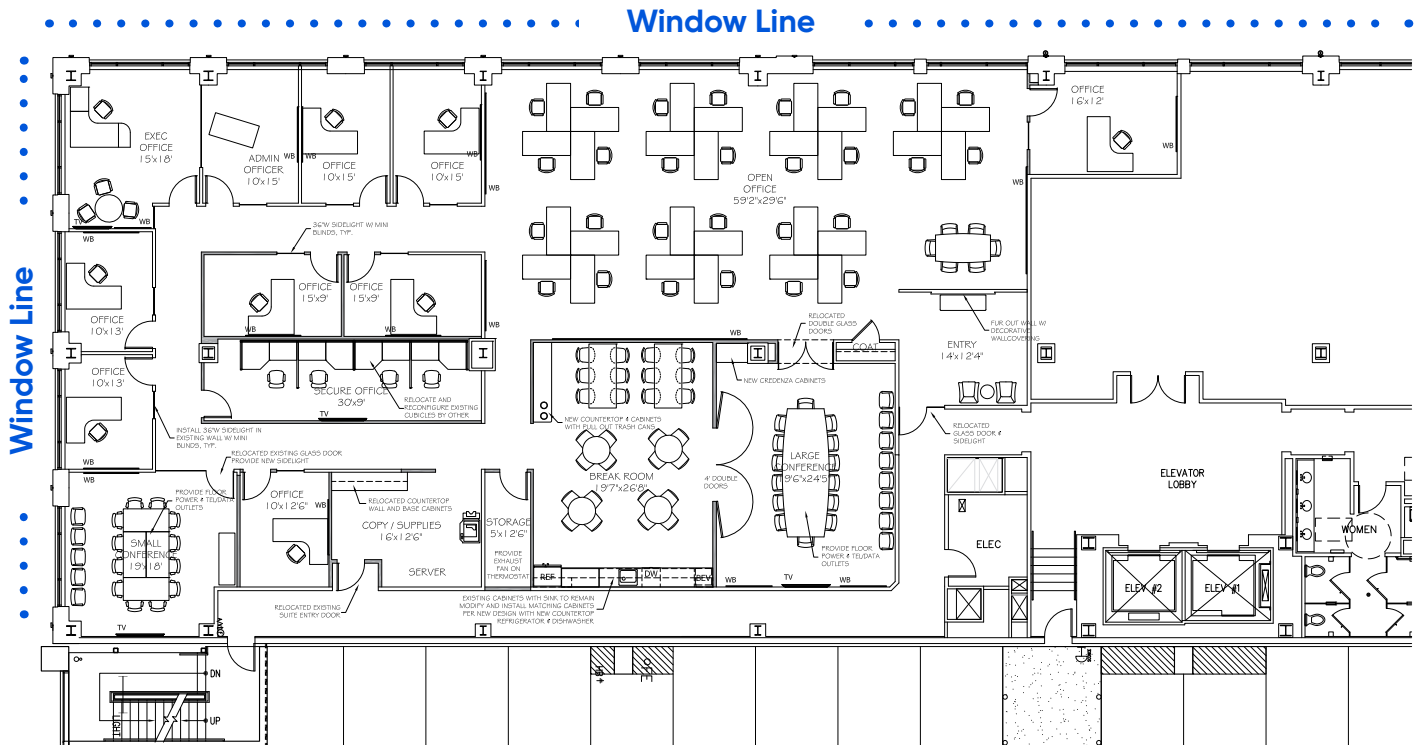

For More Information

Cresa
2 Bethesda Metro Center
Suite 900
Bethesda, MD 20814
cresa.com/washingtondc



Josh Freedenberg
301.538.0939
jfreedenberg@cresa.com



Lucia Hedke, LEED GA
202.294.5359
lucia.hedke@jll.com



National Harbor
174 Waterfront Street
Oxon Hill, MD 20745

3rd Floor - 7,334 SF

WATER VIEWS



WORKSTATIONS



CONFERENCE & LUNCH ROOM



CONFERENCE & LUNCH ROOM



For More Information

Cresa
2 Bethesda Metro Center
Suite 900
Bethesda, MD 20814
cresa.com/washingtondc



Josh Freedenberg
301.538.0939
jfreenberg@cresa.com



Lucia Hedke, LEED GA
202.294.5359
lucia.hedke@jll.com