

For Sale

cresa

North Kelowna Industrial Land

9640 McCarthy Road
Kelowna, BC V4V 1S5

Outstanding Opportunity to Purchase Prime Land in North Kelowna

Cresa is pleased to present the opportunity to purchase a 3.88 acre site in highly sought after North Kelowna. The property is ideal for both owner-users and developers, with zoning allowing for 102,000 square feet of site coverage. Permitted uses include warehousing and distribution, trucking, storage, light manufacturing, general industrial and outdoor storage.

Location. The subject property is located north of Beaver Lake Road, and 900 metres from Highway 97. Drive time to Kelowna International Airport is approximately seven minutes, while both downtown Kelowna and Vernon are less than 26 minutes away. A traffic light-

controlled intersection [with left-hand turn lane] at Beaver Lake Road and Highway 97 provides access south to downtown Kelowna, and through to #97C to Merritt and the Lower Mainland, while driving north connects with Highway #1. Within a short distance in the District of Lake Country, is a variety of restaurants, grocery and other retail services.

Zoning/Permitted Uses. The subject property is zoned I2 and I3. I2 and I3 zoning allows for a wide range of industrial uses, including manufacturing, breweries and distilleries, automotive, contractor services and warehousing.

Features:

- Premier Industrial Site
- Just off Highway 97
- Site Area - 3.88 acres
- 170,105 SF
- Serviced lot with municipal water, sewer, hydro, and gas
- Level lot in prime Beaver Lake Rd industrial submarket
- I2 (general industrial) and I3 (heavy industrial) zoning
- Site coverage 60% (102,062 SF)
- Allowable FSR (255,156 SF)
- Parcel Identifier: 030-851-424
- **Price: \$5,234,120.00 (\$1,349,000 per acre)**

For More Information:



Ross Moore
604.628.0522
rmoore@cresa.com



Arielle Hebein
604.628.8872
ahebein@cresa.com

Site Photos



Cresa © 2021. All rights reserved. The information contained in this document has been obtained from sources believed reliable. While Cresa does not doubt its accuracy, Cresa has not verified it and makes no guarantee, warranty, or representation about it. It is your responsibility to independently confirm its accuracy and completeness. Any projections, opinions, assumptions or estimates used are for example only and do not represent the current or future performance of the property. The value of this transaction to you depends on tax and other factors which should be evaluated by your tax, financial and legal advisors. You and your advisors should conduct a careful, independent investigation of the property to determine to your satisfaction the suitability of the property for your needs.



Site Plan

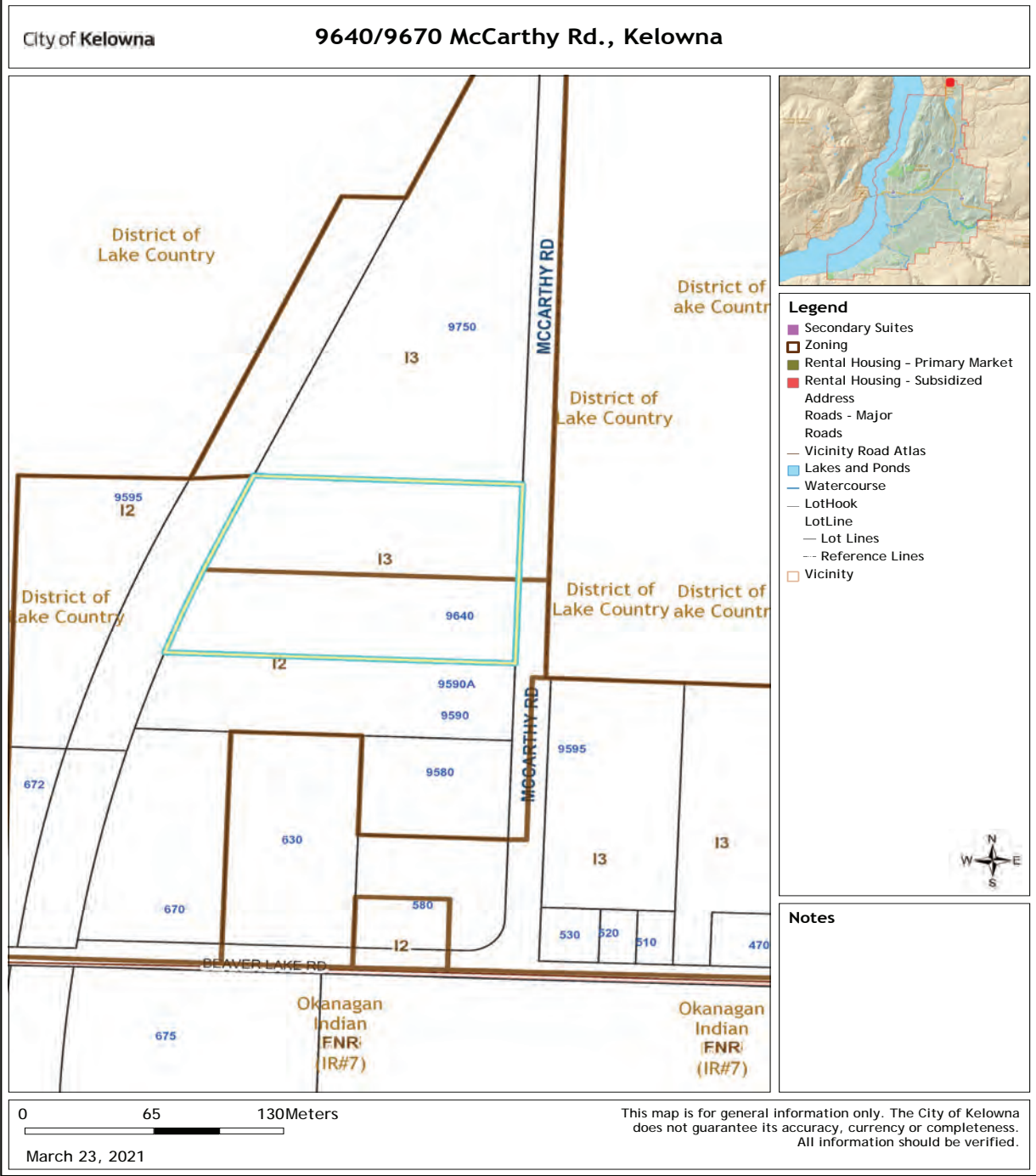

9640 McCarthy Road

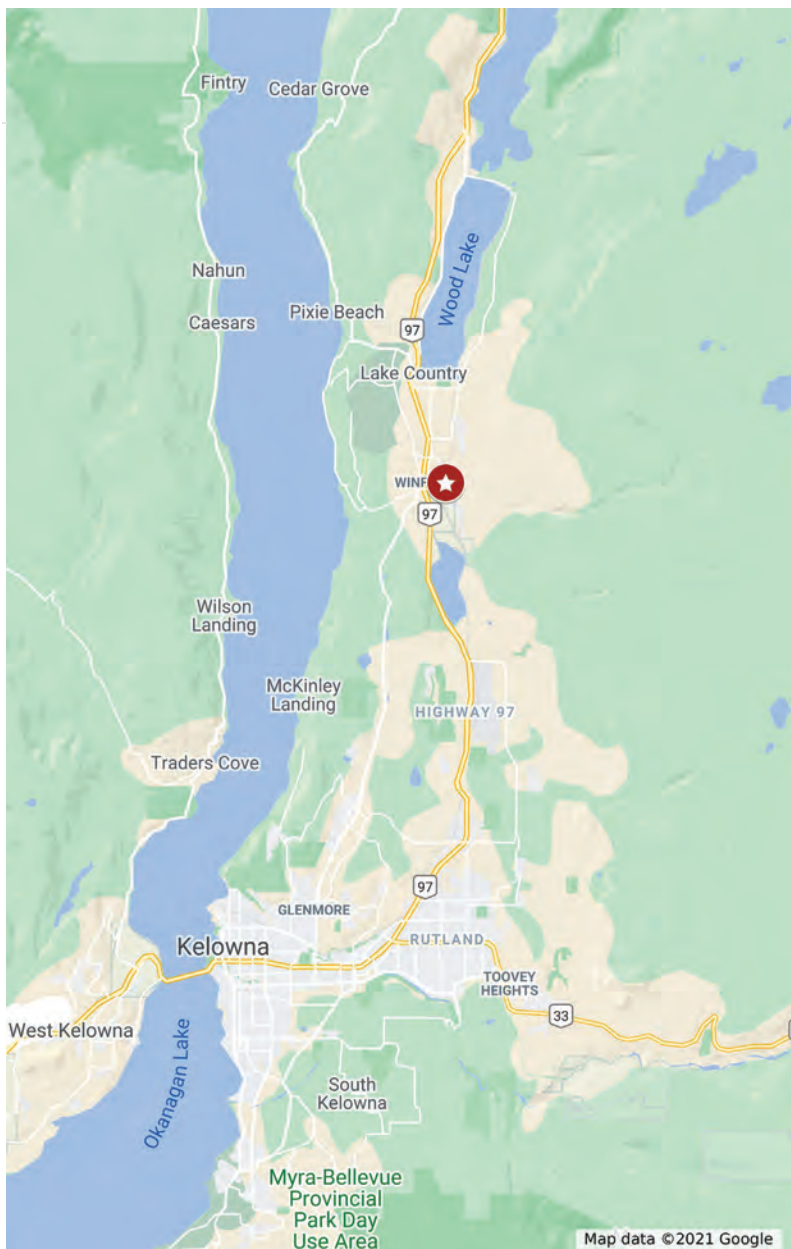

Major Roads/Highways

Yards from Beaver Lake Road, 2 minutes from Highway 97 leading south to downtown Kelowna, and north to Vernon and Trans-Canada Hwy #1

Transit

Bus Route 32 (nearest stop at Beaver Lake Road)

Proximity

7 minutes to Kelowna International Airport, 26 minutes to downtown Kelowna, 25 minutes to Vernon, 5 hours to Vancouver, and 6.5 hours to Calgary

Agent Information

Ross Moore
Senior Vice President
604 628 0522
rmoore@cresa.com

Arielle Hebein
Associate
604 628 8872
ahebein@cresa.com

Cresa | 777 Hornby St., Suite 2088 | Vancouver BC, V6Z 1S4



Cresa © 2021. All rights reserved. The information contained in this document has been obtained from sources believed reliable. While Cresa does not doubt its accuracy, Cresa has not verified it and makes no guarantee, warranty, or representation about it. It is your responsibility to independently confirm its accuracy and completeness. Any projections, opinions, assumptions or estimates used are for example only and do not represent the current or future performance of the property. The value of this transaction to you depends on tax and other factors which should be evaluated by your tax, financial and legal advisors. You and your advisors should conduct a careful, independent investigation of the property to determine to your satisfaction the suitability of the property for your needs.