

# Sublease Available



## 3003 Washington Boulevard Arlington, VA

### Video Tour Here!

### Space Profile

<b>Premises</b>	10th Floor
<b>RSF</b>	21,969 RSF
<b>Rental Rate</b>	\$43.00/SF
<b>Availability</b>	Immediate
<b>Term</b>	Through July 2024
<b>Layout</b>	10 offices and 136 workstations

### Map

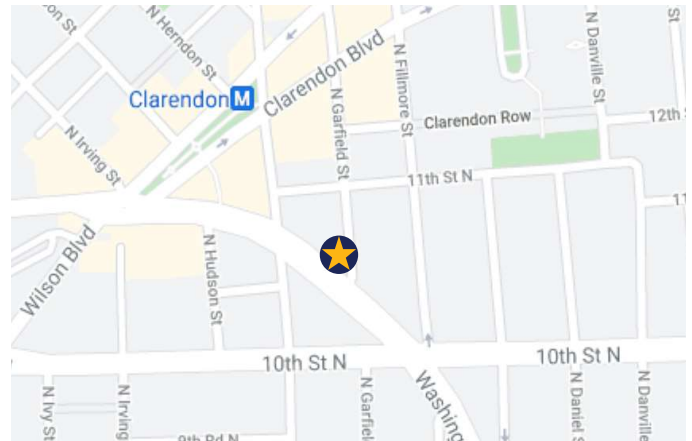

### Features

- Furniture conveys
- Tenant-only fitness center
- Rooftop terrace
- 9' finished ceilings
- Minimal columns
- Property management office on-site
- LEED Gold Certified
- Wired Certified Silver - Fiber
- Two blocks from Clarendon Metro (Orange, Silver)

### For More Information

Cresa  
7901 Jones Branch Drive  
Suite 340  
McLean, VA 22102  
[cresa.com/washingtondc](https://cresa.com/washingtondc)



Samuel A. Heiber  
202.783.3889  
[sheiber@cresa.com](mailto:sheiber@cresa.com)



Natalie A. Gosnell  
301.841.6546  
[ngosnell@cresa.com](mailto:ngosnell@cresa.com)

Even though obtained from sources deemed reliable, no warranty or representation, express or implied, is made as to the accuracy of the information herein, and it is subject to errors, omissions, change of price, rental or other conditions, withdrawal without notice, and to any special listing conditions imposed by our principals.





## 3003 Washington Boulevard Arlington, VA

10th Floor – 21,969 SF

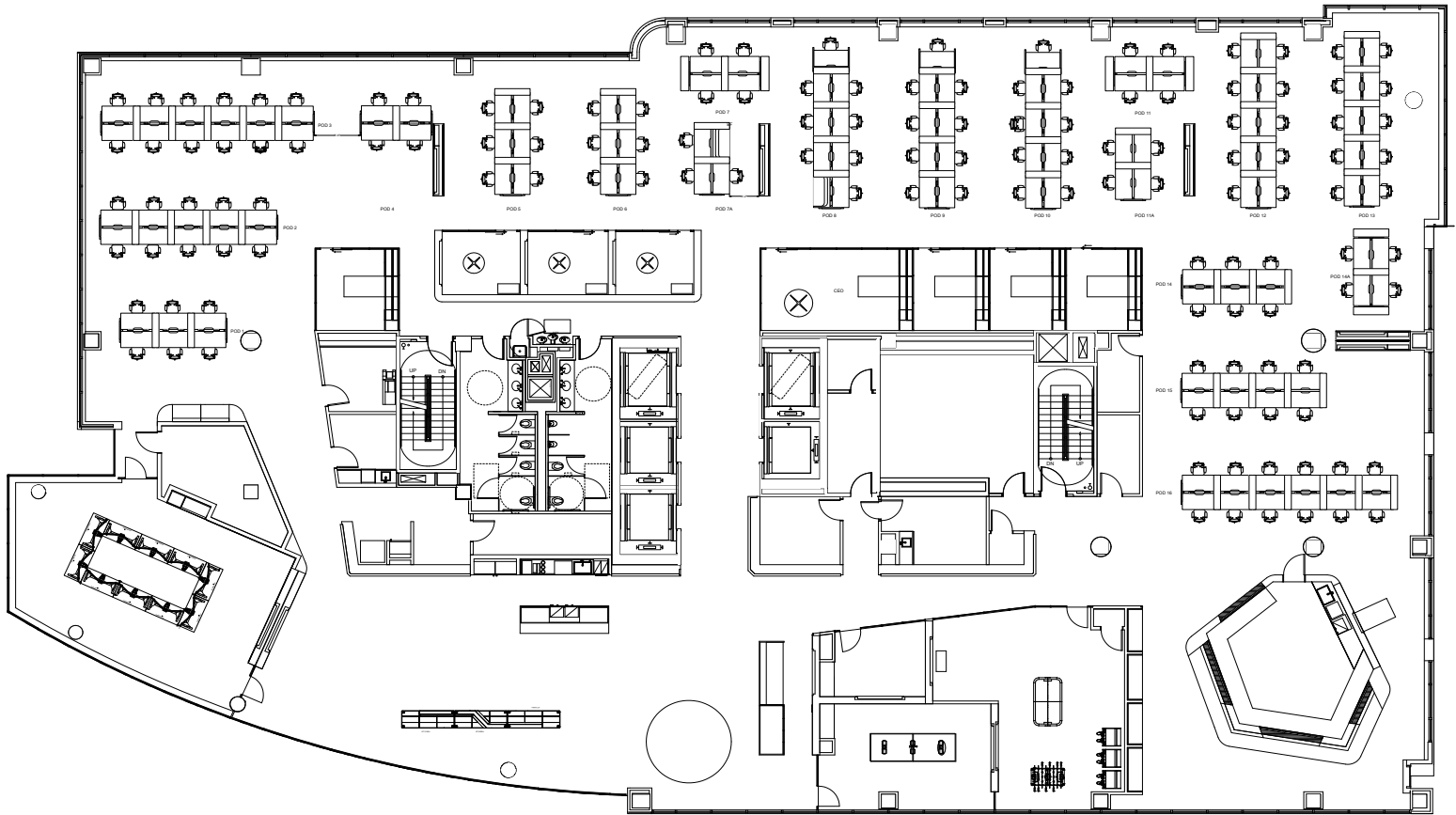

### For More Information

Cresa  
7901 Jones Branch Drive  
Suite 340  
McLean, VA 22102  
[cresa.com/washingtondc](http://cresa.com/washingtondc)



Samuel A. Heiber  
202.783.3889  
[sheiber@cresa.com](mailto:sheiber@cresa.com)



Natalie A. Gosnell  
301.841.6546  
[ngosnell@cresa.com](mailto:ngosnell@cresa.com)





3003 Washington Boulevard  
Arlington, VA

## Interior Photos



## For More Information

Cresa  
7901 Jones Branch Drive  
Suite 340  
McLean, VA 22102  
[cresa.com/washingtondc](http://cresa.com/washingtondc)



Samuel A. Heiber  
202.783.3889  
[sheiber@cresa.com](mailto:sheiber@cresa.com)



Natalie A. Gosnell  
301.841.6546  
[ngosnell@cresa.com](mailto:ngosnell@cresa.com)