



# Sublease Available

**1300 Yonge Street,  
Suite 701  
Toronto, Ontario**

## Space Profile

<b>Premises</b>	Suite 701
<b>RSF</b>	8,487 RSF
<b>Net Rent</b>	Please contact Agent
<b>Additional Rent</b>	\$22.05 PSF (2019)
<b>Availability</b>	120 days
<b>Term</b>	October 30, 2021
<b>Building Class</b>	B
<b>Built</b>	1972

## Map



## Features

- Substantial natural light
- Elevator exposure
- Good variety of open and closed workspace
- Flexible occupancy date
- Furniture negotiable

## For More Information

**Cresa Toronto Inc., Brokerage**  
170 University Avenue  
Suite 1100  
Toronto, Ontario  
M5H 3B3  
[cresa.com/toronto](http://cresa.com/toronto)



**Jamie Grossman**  
Managing Principal, Broker  
416.847.2670  
[jgrossman@cresa.com](mailto:jgrossman@cresa.com)



**Matthew Rosenberg**  
Sales Representative  
416.847.6220  
[mrosenberg@cresa.com](mailto:mrosenberg@cresa.com)

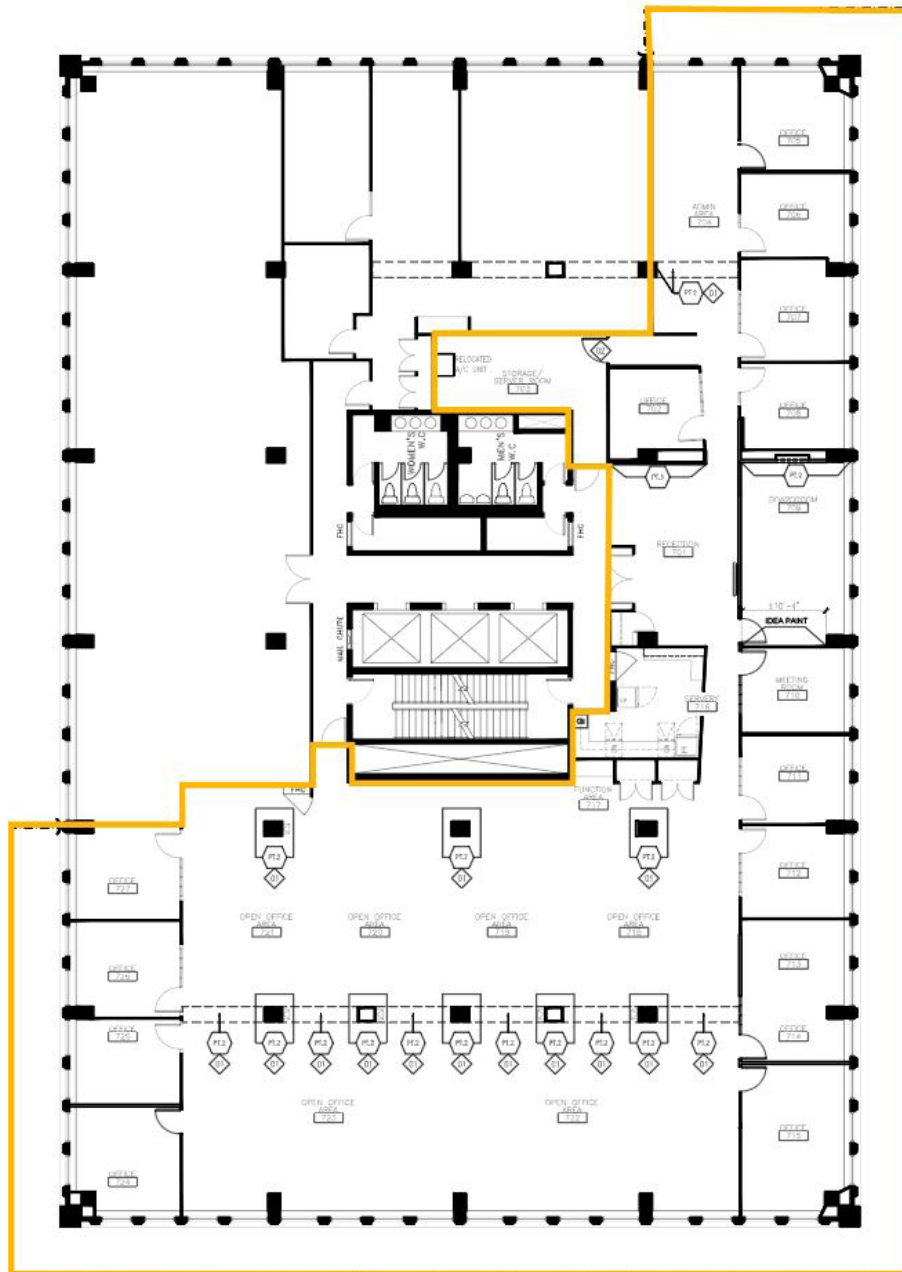





1300 Yonge Street,  
Suite 701  
Toronto, Ontario

## Interior Photos

