

201 Mission Street

201 Mission Street
San Francisco, CA

Space Profile:

Premises	6th Floor
RSF	6,376 RSF
Rental Rate	Call for information
Availability	Summer 2020
Term	Through 10/31/2021



Features:

- New buildout with new furniture
- Potentially deliverable on a plug-n-play basis
- City outlooks with good setbacks
- Open area with perimeter private offices

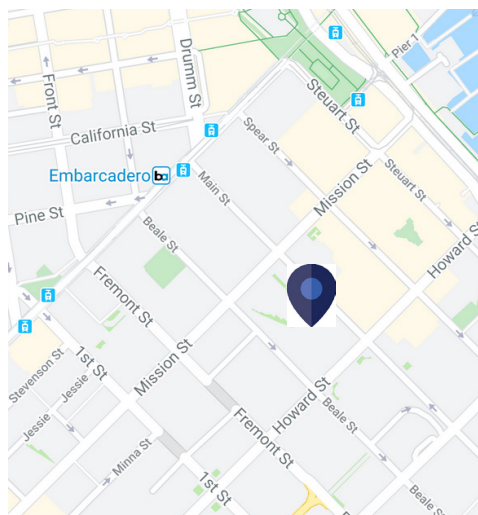

Contact:

Will Scovill
415.394.1045
wscovill@cresa.com
BRE# 01751649



201 Mission Street San Francisco, CA

Contact:

Will Scovill
415.394.1045
wscovill@cresa.com
BRE# 01751649



Cresa © 2020. All rights reserved. The information contained in this document has been obtained from sources believed reliable. While Cresa does not doubt its accuracy, Cresa has not verified it and makes no guarantee, warranty, or representation about it. It is your responsibility to independently confirm its accuracy and completeness. Any projections, opinions, assumptions or estimates used are for example only and do not represent the current or future performance of the property. The value of this transaction to you depends on tax and other factors which should be evaluated by your tax, financial and legal advisors. You and your advisors should conduct a careful, independent investigation of the property to determine to your satisfaction the suitability of the property for your needs.

201 Mission Street

San Francisco, CA

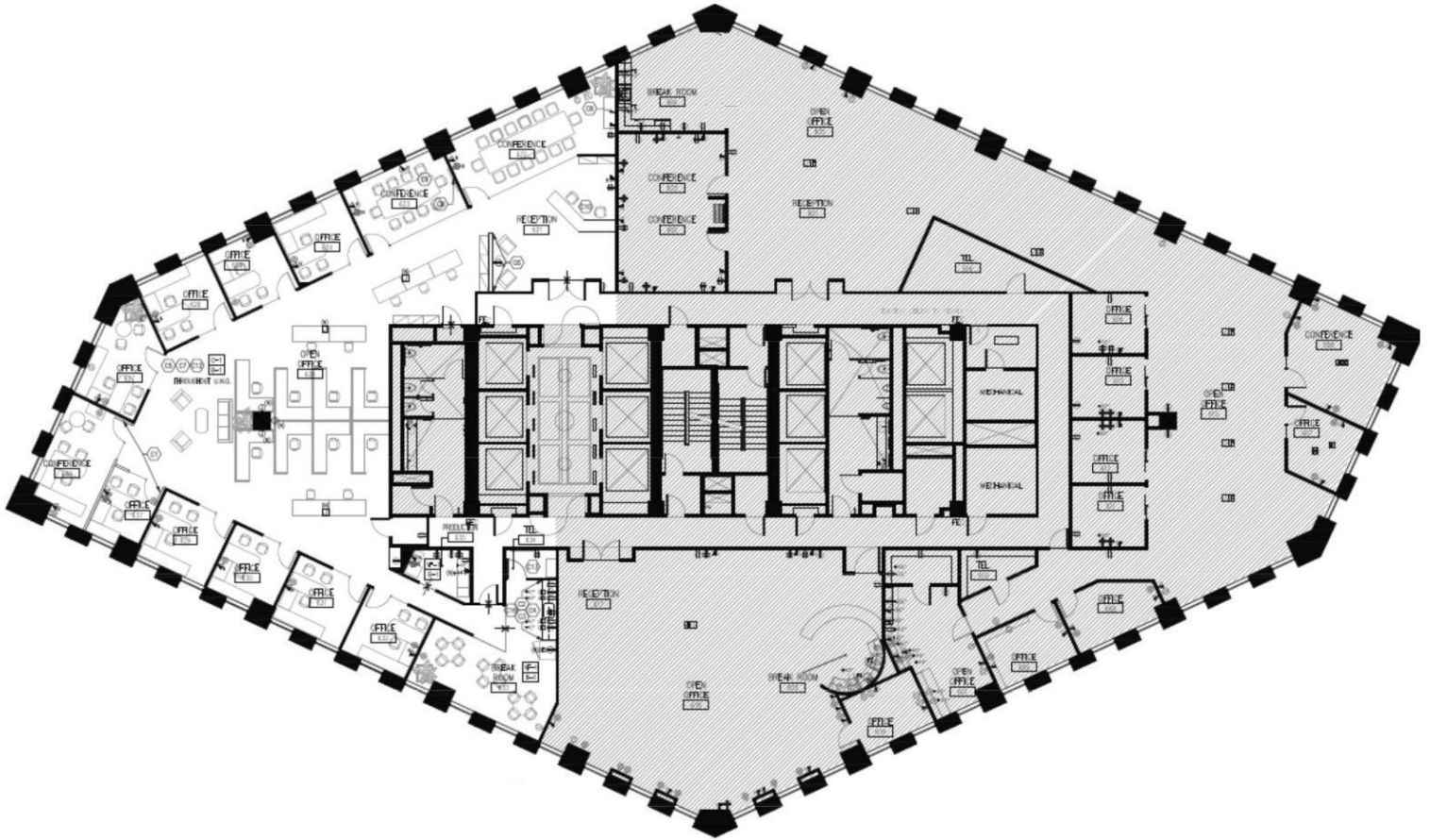

Will Scovill
415.394.1045
wscovill@cresa.com
BRE# 01751649

Cresa © 2020. All rights reserved. The information contained in this document has been obtained from sources believed reliable. While Cresa does not doubt its accuracy, Cresa has not verified it and makes no guarantee, warranty, or representation about it. It is your responsibility to independently confirm its accuracy and completeness. Any projections, opinions, assumptions or estimates used are for example only and do not represent the current or future performance of the property. The value of this transaction to you depends on tax and other factors which should be evaluated by your tax, financial and legal advisors. You and your advisors should conduct a careful, independent investigation of the property to determine to your satisfaction the suitability of the property for your needs.