

# Sublease Available

**Sorenson Research Park  
860 West LeVoy Drive  
Taylorsville, UT**

### Space Profile

- Premises RSF** Up to 52,200 RSF, Divisible to 17,500 RSF
- Rental Rate** \$18.75 per SF, full service
- Availability** October 2019: Master lease exp. 6/60/2022
- Submarket** Sorenson Research Park
- Parking** Up to 6/1,000 SF

### Features

- Located in the center of Salt Lake Valley at Sorenson Research Park, an upscale campus-style-environment
- Excellent access to I-15 and I-215
- Close proximity to Salt Lake Community College, two golf courses and the Jordan River Parkway trail system
- UTA bus stop and restaurant/hotel amenities nearby
- Spacious 2-story lobby atrium
- 250 cubes in place and available for use
- 4 Conference rooms and multiple training rooms with furniture
- 10 furnished offices
- Emergency generator and UPS

### Map

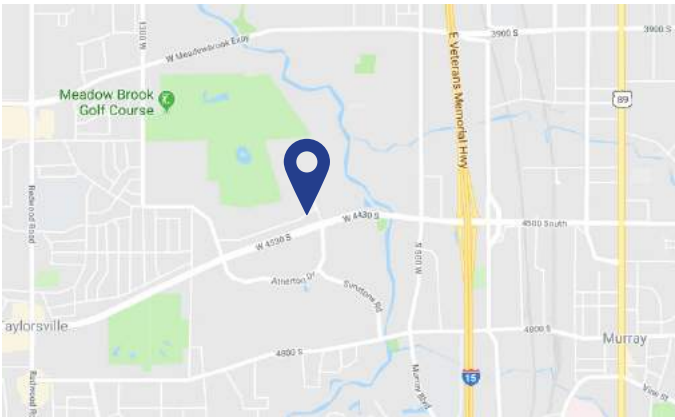

### For More Information

**Mike Chappell**  
Vice President  
801.300.4516 (office)  
801.558.0975 (cell)  
mchappell@cresa.com

**Cresa**  
136 South Main Street  
Suite 500  
Salt Lake City, UT 84101

Even though obtained from sources deemed reliable, no warranty or representation, express or implied, is made as to the accuracy of the information herein, and it is subject to errors, omissions, change of price, rental or other conditions, withdrawal without notice, and to any special listing conditions imposed by our principals.





**Sorenson Research Park  
860 West LeVoy Drive  
Taylorsville, UT**

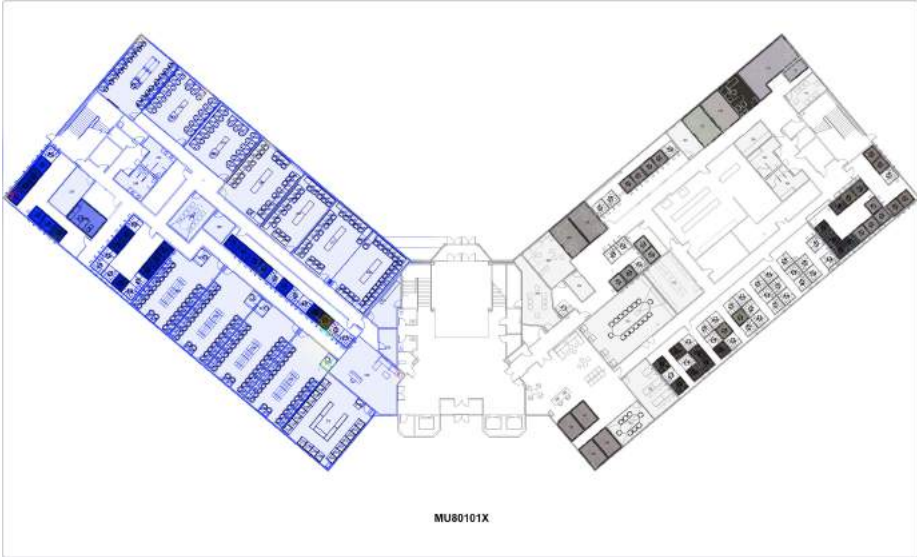

**1st Floor**  
(entire south wing available)

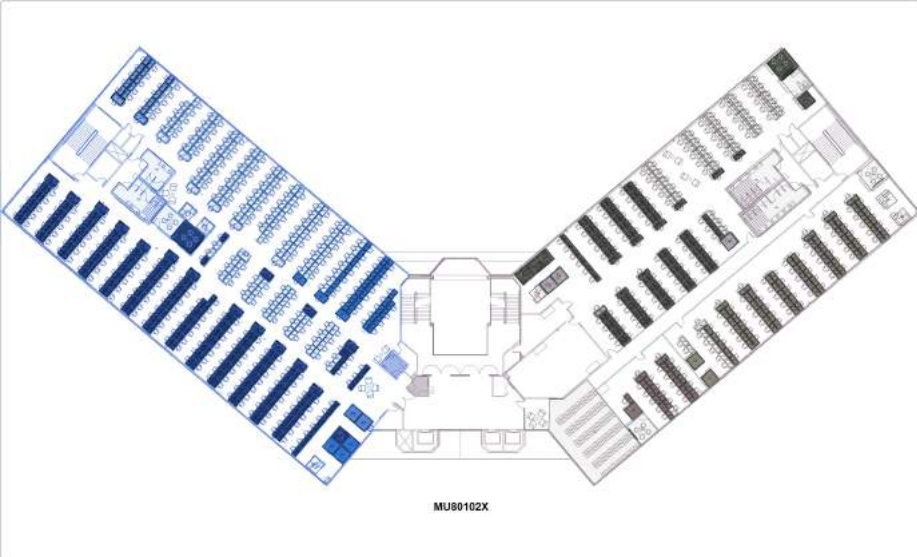

**2nd Floor**  
(entire south wing available)

**3rd Floor**  
(entire south wing available)

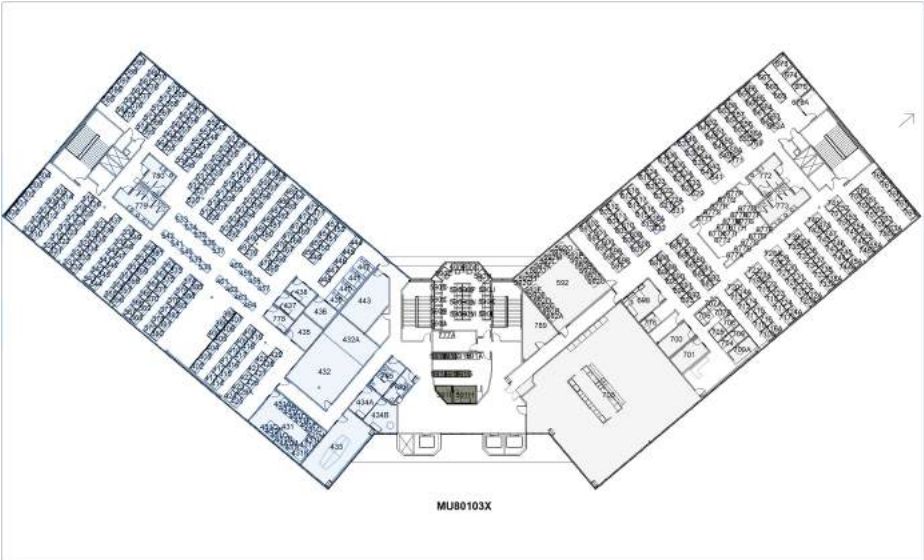

**For More Information**

**Mike Chappell**  
Vice President  
801.300.4516 (office)  
801.558.0975 (cell)  
mchappell@cresa.



Sorenson Research Park  
860 West LeVoy Drive  
Taylorsville, UT

## Interior Photos



## For More Information

**Mike Chappell**  
Vice President  
801.300.4516 (office)  
801.558.0975 (cell)  
mchappell@cresa.