



Space Available For Sublease

# Gateway Mesa Station

1833 W Main Street | Bldg 4 | Suite 138  
Mesa, 85201

## Overview

Building:	1833 W Main St, Bldg 4, Suite 138, Mesa, AZ 85201
Available:	Suite 138   2,280 SF
Term:	Through October 31, 2028
Availability:	Immediate
Rental Rate:	\$0.95/SF/Month, NNN
Parking:	3.10/1,000 SF

Click Here For Virtual Tour  **Matterport**

## Property Highlights

- 1 mile East of Loop 101 Freeway and Next to Valley Metro Rail Stop
- Property is in an Opportunity Zone
- Space is Located at the Front of the Property
- Recently Renovated

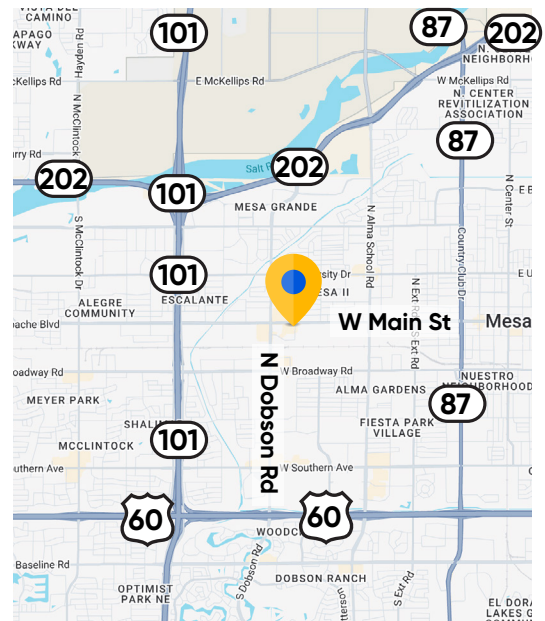

## For more information:



**Brandon Clarke**  
602.770.3464 mobile  
bclarke@cresa.com



**Jake Bonnell**  
602.826.8615 mobile  
jbbonnell@cresa.com

## Cresa

2398 E Camelback Rd. Suite 900  
Phoenix, AZ 85016

Sublease Available

cresa

1833 W Main Street, Bldg 4  
Mesa, AZ

Suite 138 | 2,280 SF

Click Here For Virtual Tour  Matterport®

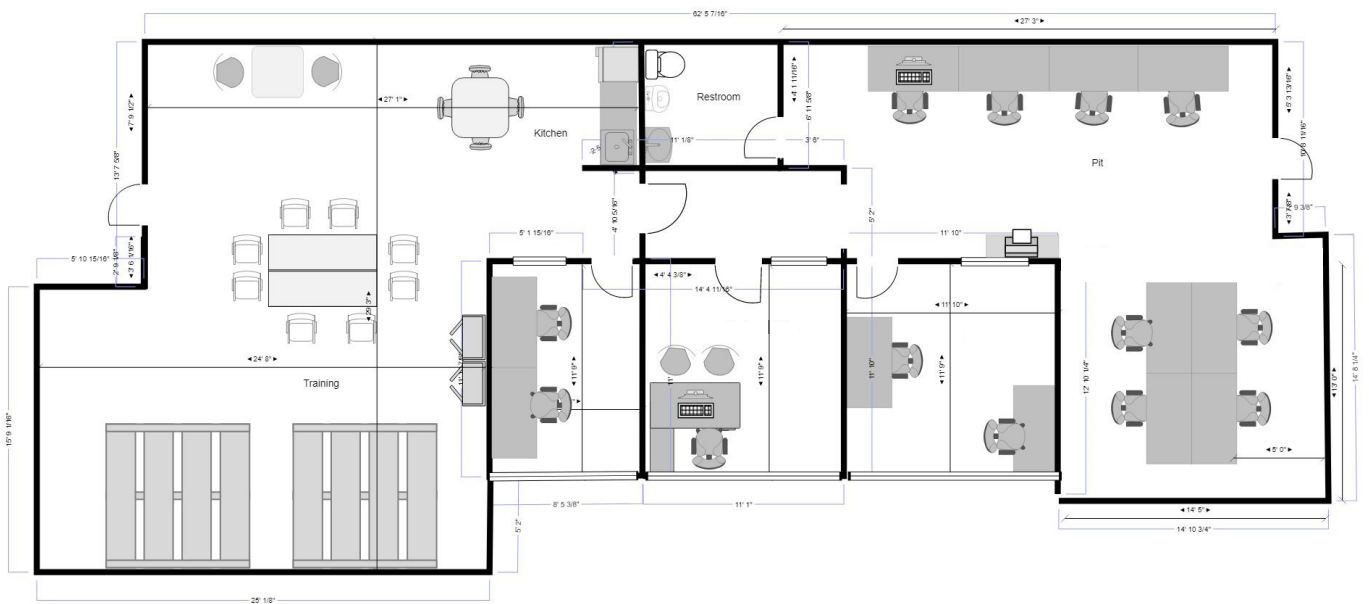

Cresa © 2025. All rights reserved. The information contained in this document has been obtained from sources believed reliable. While Cresa does not doubt its accuracy, Cresa has not verified it and makes no guarantee, warranty, or representation about it. It is your responsibility to independently confirm its accuracy and completeness. Any projections, opinions, assumptions or estimates used are for example only and do not represent the current or future performance of the property. The value of this transaction to you depends on tax and other factors which should be evaluated by your tax, financial and legal advisors. You and your advisors should conduct a careful, independent investigation of the property to determine to your satisfaction the suitability of the property for your needs.



Sublease Available

cresa

# 1833 W Main Street, Bldg 4

Mesa, AZ

Click Here For Virtual Tour  **Matterport**





Sublease Available

cresa

# 1833 W Main Street, Bldg 4

Mesa, AZ

Location & Amenities

Click Here For Virtual Tour  **Matterport®**



For more information:

**Brandon Clarke**  
602.770.3464 mobile  
bclarke@cresa.com

**Jake Bonnell**  
602.826.8615 mobile  
jbonnell@cresa.com

**Cresa**  
2398 E Camelback Rd. Suite 900  
Phoenix, AZ 85016