

# For Sublease



## 1650 South Price Road Building 15

Chandler, AZ 85286

### Space Profile:

<b>Premises</b>	1st Floor/Suite #100
<b>RSF</b>	Approximately 10,000-39,000 SF
<b>Rental Rate</b>	\$29.00/FS
<b>Available</b>	Immediately
<b>Term</b>	April 30, 2030
<b>Building Class</b>	Class A
<b>Built</b>	2020
<b>Parking</b>	5.40/1000 SF
<b>Submarkets</b>	Chandler, Price Road Corridor

### Features:

- Air Conditioning
- Conferencing Facility
- Courtyard
- Food Service
- Property Manager on Site
- Restaurant
- Signage
- Furniture can be made available
- Access to Loop 101 & 202

### For more information contact:



**Jason Malcolm**  
Sr. Vice President  
602.648.4698  
jmalcolm@cresa.com



**Rod Beach**  
Principal  
602.690.7050  
rbeach@cresa.com



# 1650 South Price Road

Bldg 15 - 10,000-39,000 RSF

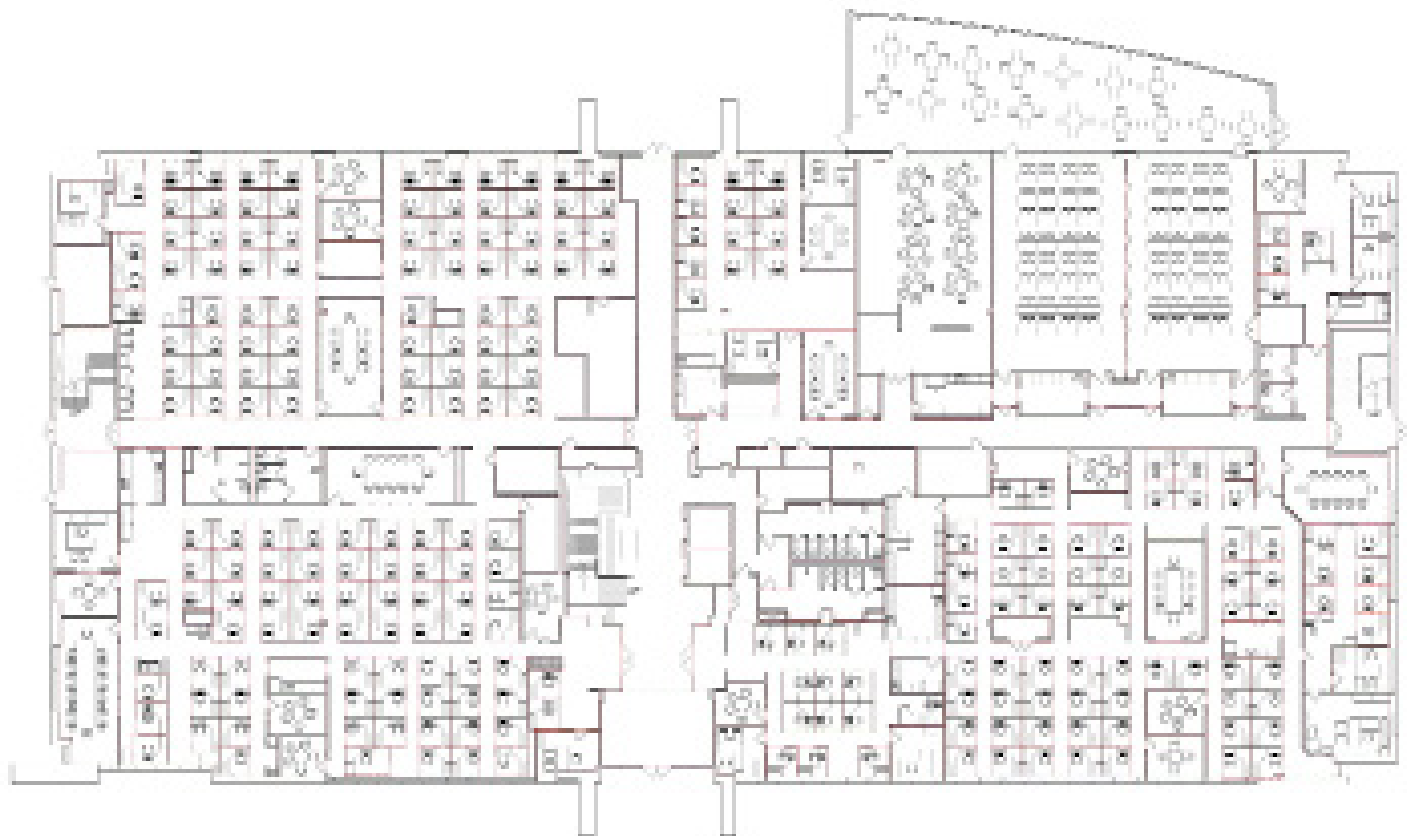

LEVEL 1 - 10,000-39,000 RSF

cresa

Cresa © 2019. All rights reserved. The information contained in this document has been obtained from sources believed reliable. While Cresa does not doubt its accuracy, Cresa has not verified it and makes no guarantee, warranty, or representation about it. It is your responsibility to independently confirm its accuracy and completeness. Any projections, opinions, assumptions or estimates used are for example only and do not represent the current or future performance of the property. The value of this transaction to you depends on tax and other factors which should be evaluated by your tax, financial and legal advisors. You and your advisors should conduct a careful, independent investigation of the property to determine to your satisfaction the suitability of the property for your needs.



# 1650 South Price Road

Bldg 15 - 10,000-39,000 RSF

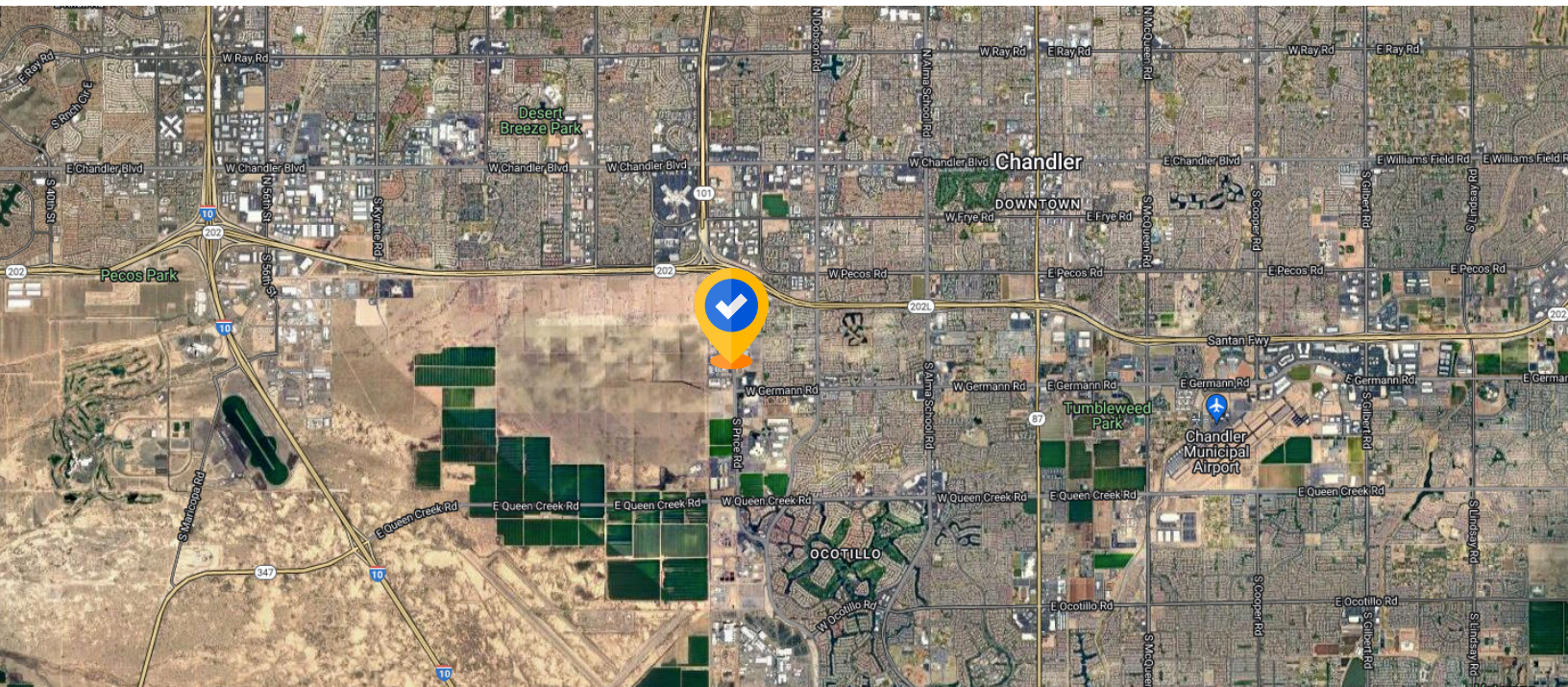
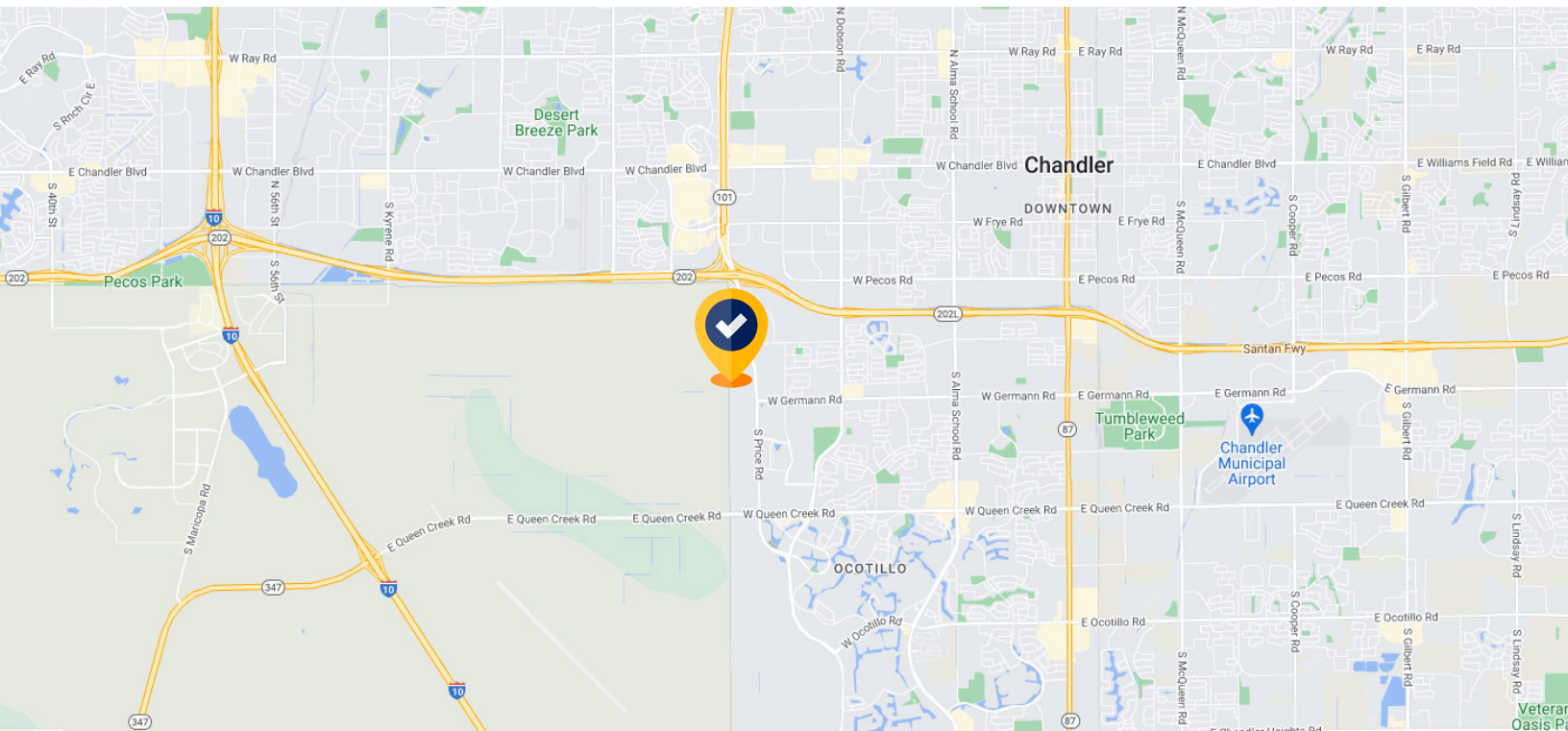

Cresa © 2019. All rights reserved. The information contained in this document has been obtained from sources believed reliable. While Cresa does not doubt its accuracy, Cresa has not verified it and makes no guarantee, warranty, or representation about it. It is your responsibility to independently confirm its accuracy and completeness. Any projections, opinions, assumptions or estimates used are for example only and do not represent the current or future performance of the property. The value of this transaction to you depends on tax and other factors which should be evaluated by your tax, financial and legal advisors. You and your advisors should conduct a careful, independent investigation of the property to determine to your satisfaction the suitability of the property for your needs.





**1650 South Price Road**  
Chandler, AZ 85286

## Contact:



**Jason Malcolm**  
602.648.4698  
jmalcolm@cresa.com



**Rod Beach**  
602.648.7354  
rbeach@cresa.com



**cresa** ::

Cresa © 2021. All rights reserved. The information contained in this document has been obtained from sources believed reliable. While Cresa does not doubt its accuracy, Cresa has not verified it and makes no guarantee, warranty, or representation about it. It is your responsibility to independently confirm its accuracy and completeness. Any projections, opinions, assumptions or estimates used are for example only and do not represent the current or future performance of the property. The value of this transaction to you depends on tax and other factors which should be evaluated by your tax, financial and legal advisors. You and your advisors should conduct a careful, independent investigation of the property to determine to your satisfaction the suitability of the property for your needs.





**1650 South Price Road**  
Chandler, AZ 85286



**cresa**

Cresa © 2021. All rights reserved. The information contained in this document has been obtained from sources believed reliable. While Cresa does not doubt its accuracy, Cresa has not verified it and makes no guarantee, warranty, or representation about it. It is your responsibility to independently confirm its accuracy and completeness. Any projections, opinions, assumptions or estimates used are for example only and do not represent the current or future performance of the property. The value of this transaction to you depends on tax and other factors which should be evaluated by your tax, financial and legal advisors. You and your advisors should conduct a careful, independent investigation of the property to determine to your satisfaction the suitability of the property for your needs.