

Sublease Available

1818 Market Street
Philadelphia, PA

Sublease Profile

Floor	Entire 25th
Term	Will consider 3 years up to 3/2032
Building Class	A
Building Renovated	2015
Parking	Negotiable

Suites, Occupancy Dates & Condition

South Suite	North Suite	Full Floor
12,959 SF	6,431 - 16,440 SF	29,399 SF
May 15, 2020	120 Days from Permit	120 Days from Permit
Spec Suite	Raw Space	Spec & Raw Space

Space Details

South Suite: 12,959 RSF

- Plug & Play - Constructed & Furnished
- ~100 workstations, 9 private offices, 2 conference rooms, 1 huddle, 2 phone rooms, and kitchenette

North Suite: 6,431 - 16,440 RSF

- Currently raw space
- Tenant Improvement Allowance Available
- Conceptual test-fits shown below (construction pricing available upon request)

Full Floor: 29,399 RSF

- Expanded window line and unobstructed views
- Fully renovated common areas & restrooms

Building Amenities

- Tenant-only gym with showers and lockers; conferencing facility (10-seat) & training facility (36-seat)
- Saxby's Coffee & Marathon Grill
- 24/7 Security

For More Information



Eric Pinchak
610.684.1993
epinchak@cresa.com



Jeff Baker
610.825.2292
jbaker@cresa.com

Even though obtained from sources deemed reliable, no warranty or representation, express or implied, is made as to the accuracy of the information herein, and it is subject to errors, omissions, change of price, rental or other conditions, withdrawal without notice, and to any special listing conditions imposed by our principals.

1 Fayette Street, Suite 100, Conshohocken, PA 19428



cresa

Market St

**North
16,440 SF
(Raw Space)**

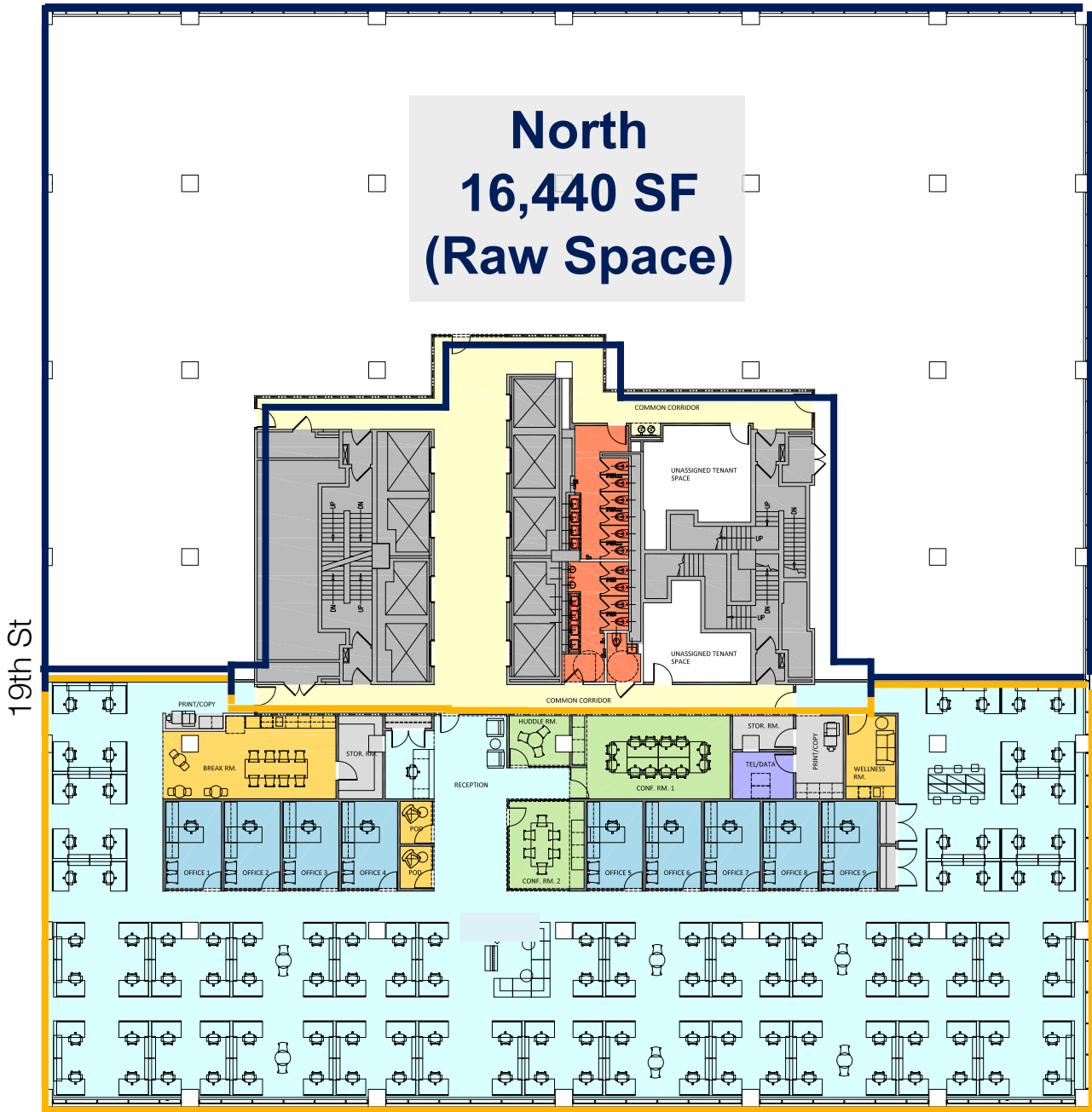

19th St

For More Information

Jeff Baker
610.825.2292
jbaker@cresa.com

Eric Pinchak
610.684.1993
epinchak@cresa.com

**South
12,959 SF
(Spec Suite)**

Area Types

- CIRCULATION
- COMMON / AMENITY
- OPEN OFFICE
- CLOSED OFFICE
- CONFERENCE
- SUPPORT / UTILITY / STOR.
- IT
- BASE BLDG. RESTROOM