

**For Sublease**

## 5291 California Avenue 3rd Floor

Irvine, CA 92617

### Space Profiles:

<b>Sublease</b>	3rd Floor
<b>RSF</b>	6,378 RSF
<b>Rental Rate</b>	\$2.50/SF FSG
<b>LED</b>	July 2026
<b>Furniture</b>	Plug and Play Optional

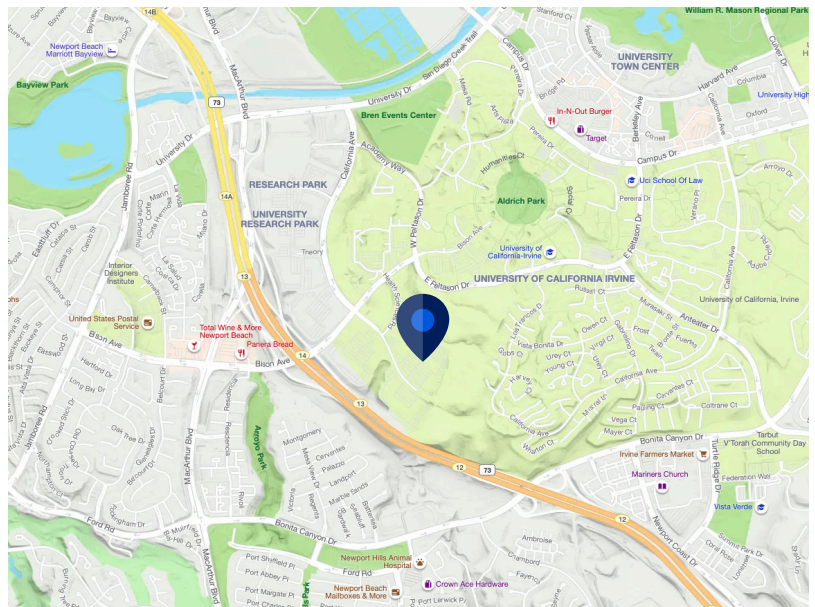

### Contact:



**Mark Bennett**  
949.491.8615  
mcbennett@cresa.com  
BRE#00869222



**Isabella Zelinger**  
818.903.9274  
izelinger@cresa.com  
BRE#02120763



# 5291 California Avenue

3rd Floor - 6,378 RSF

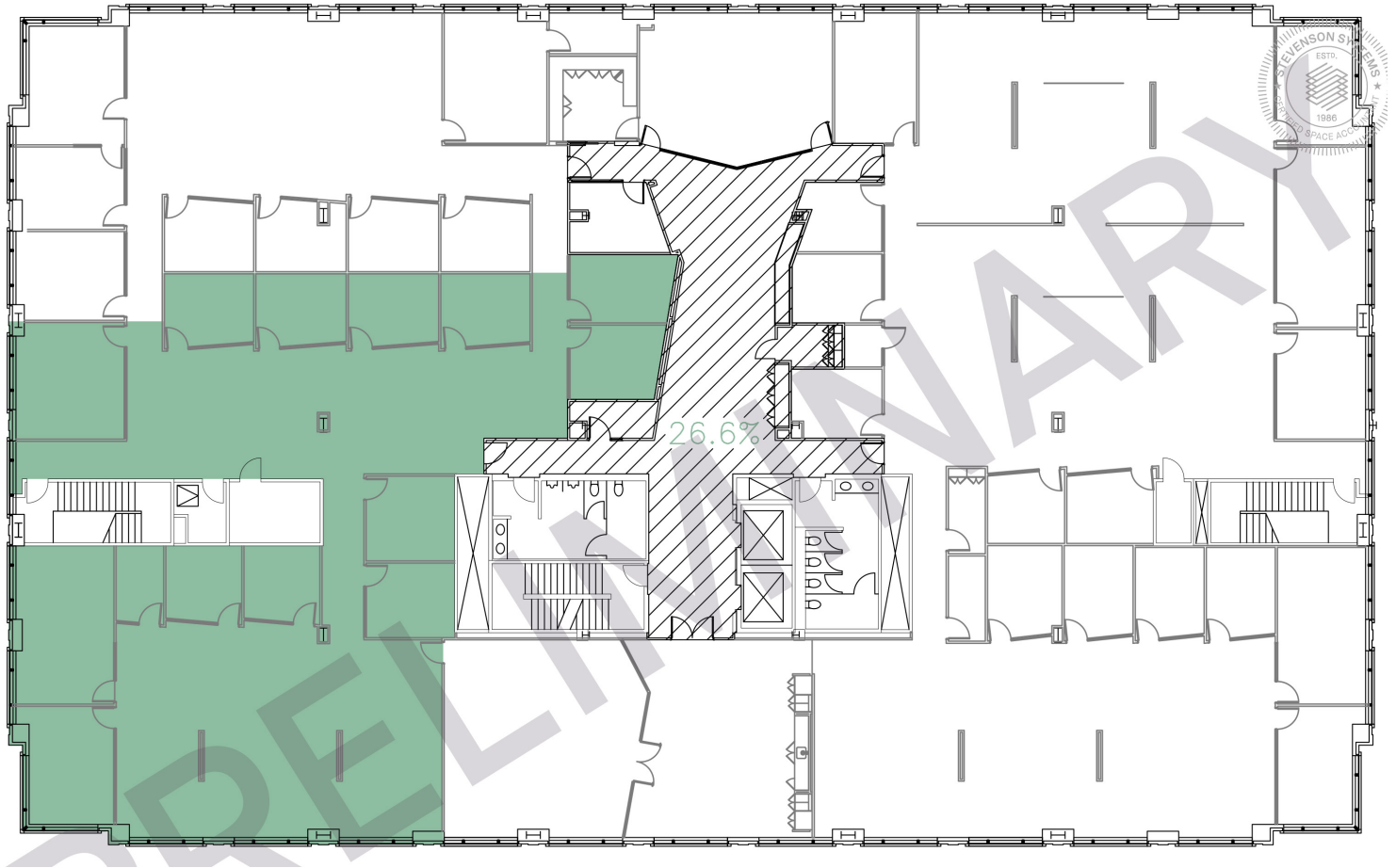

cresa

Cresa © 2021. All rights reserved. The information contained in this document has been obtained from sources believed reliable. While Cresa does not doubt its accuracy, Cresa has not verified it and makes no guarantee, warranty, or representation about it. It is your responsibility to independently confirm its accuracy and completeness. Any projections, opinions, assumptions or estimates used are for example only and do not represent the current or future performance of the property. The value of this transaction to you depends on tax and other factors which should be evaluated by your tax, financial and legal advisors. You and your advisors should conduct a careful, independent investigation of the property to determine to your satisfaction the suitability of the property for your needs.





## 5291 California Avenue

### 3rd Floor – 6,378 RSF



cresa

Cresa © 2021. All rights reserved. The information contained in this document has been obtained from sources believed reliable. While Cresa does not doubt its accuracy, Cresa has not verified it and makes no guarantee, warranty, or representation about it. It is your responsibility to independently confirm its accuracy and completeness. Any projections, opinions, assumptions or estimates used are for example only and do not represent the current or future performance of the property. The value of this transaction to you depends on tax and other factors which should be evaluated by your tax, financial and legal advisors. You and your advisors should conduct a careful, independent investigation of the property to determine to your satisfaction the suitability of the property for your needs.





**5291 California Avenue**

**3rd Floor – 6,378 RSF**

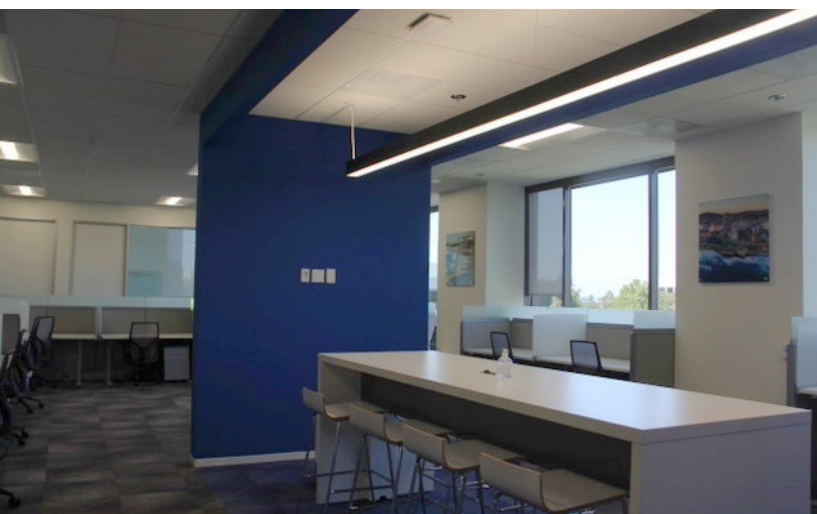

**cresa** ::

Cresa © 2021. All rights reserved. The information contained in this document has been obtained from sources believed reliable. While Cresa does not doubt its accuracy, Cresa has not verified it and makes no guarantee, warranty, or representation about it. It is your responsibility to independently confirm its accuracy and completeness. Any projections, opinions, assumptions or estimates used are for example only and do not represent the current or future performance of the property. The value of this transaction to you depends on tax and other factors which should be evaluated by your tax, financial and legal advisors. You and your advisors should conduct a careful, independent investigation of the property to determine to your satisfaction the suitability of the property for your needs.