

# Sublease Available

410 Park Avenue  
New York, NY

## Space Profile

<b>Premises</b>	Entire 10th Floor
<b>RSF</b>	14,278 RSF
<b>Possession</b>	March 15, 2026
<b>Term</b>	Through May 2029 or Through June 2034

## Highlights

- Rare private terrace
- New high-end installation
- Fully furnished and wired
- 8 offices, 44 workstations
- 1 boardroom (20 seats), 1 large conference room (14 seats)
- 2 small conference rooms (8 seats), 1 meeting room
- Eat-in kitchen, dedicated reception (4 seats)

## Ideal For

Private equity firms, hedge funds, family offices, early-stage VC/tech firms

## Building Features

- Amenities include a fitness center, executive showers, conference center, lounge/events space, and a golf simulator
- Concierge services
- Prestigious tenant roster
- Surrounded by major subway and bus lines

## For More Information

**Gregg Cohen**  
917.684.1764 (Cell)  
gcohen@cresa.com

**Sam Steinberg**  
631.848.1682 (Cell)  
ssteinberg@cresa.com

1133 Avenue of the Americas, Ste 2900 | New York, NY 10036

Even though obtained from sources deemed reliable, no warranty or representation, express or implied, is made as to the accuracy of the information herein, and it is subject to errors, omissions, change of price, rental or other conditions, withdrawal without notice, and to any special listing conditions imposed by our principals.



# Sublease Available

410 Park Avenue  
New York, NY

10th Floor - 14,278 SF

Meeting Space

Private Office

Kitchen/pantry

Private Terrace

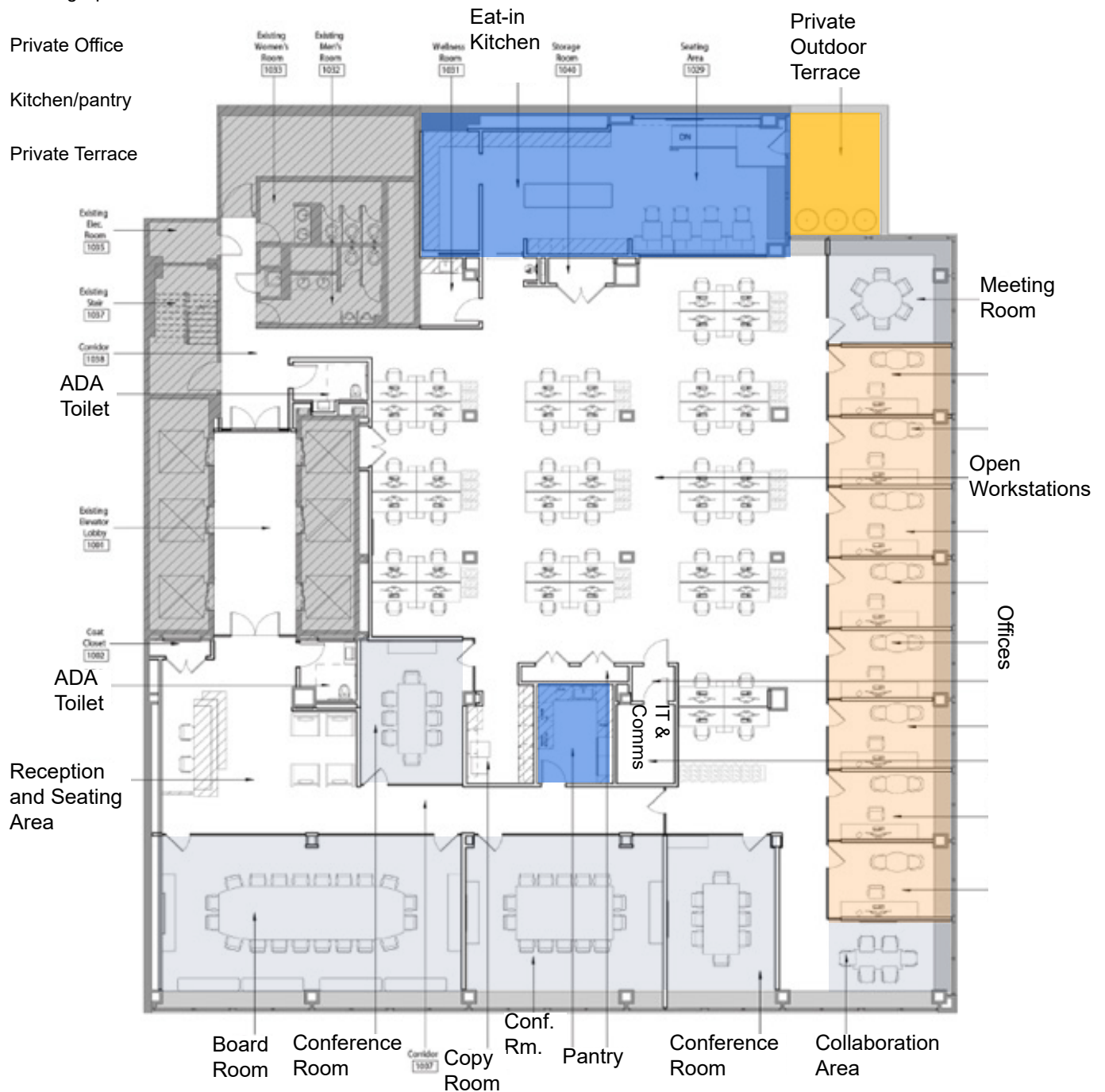

## For More Information

**Gregg Cohen**

917.684.1764 (Cell)

gcohen@cresa.com

**Sam Steinberg**

631.848.1682 (Cell)

ssteinberg@cresa.com

1133 Avenue of the Americas, Ste 2900 | New York, NY 10036

Even though obtained from sources deemed reliable, no warranty or representation, express or implied, is made as to the accuracy of the information herein, and it is subject to errors, omissions, change of price, rental or other conditions, withdrawal without notice, and to any special listing conditions imposed by our principals.

**cresa**





**410 Park Avenue**

**New York, NY**



## For More Information

**Gregg Cohen**

917.684.1764 (Cell)

gcohen@cresa.com

**Sam Steinberg**

631.848.1682 (Cell)

ssteinberg@cresa.com

1133 Avenue of the Americas, Ste 2900 | New York, NY 10036

Even though obtained from sources deemed reliable, no warranty or representation, express or implied, is made as to the accuracy of the information herein, and it is subject to errors, omissions, change of price, rental or other conditions, withdrawal without notice, and to any special listing conditions imposed by our principals.

**cresa** 



# Sublease Available

410 Park Avenue  
New York, NY



## For More Information

**Gregg Cohen**

917.684.1764 (Cell)

[gcohen@cresa.com](mailto:gcohen@cresa.com)

**Sam Steinberg**

631.848.1682 (Cell)

[ssteinberg@cresa.com](mailto:ssteinberg@cresa.com)

1133 Avenue of the Americas, Ste 2900 | New York, NY 10036

Even though obtained from sources deemed reliable, no warranty or representation, express or implied, is made as to the accuracy of the information herein, and it is subject to errors, omissions, change of price, rental or other conditions, withdrawal without notice, and to any special listing conditions imposed by our principals.

**cresa** 