

35 PARK LANE, W1

3RD FLOOR

FULLY FITTED OFFICE SPACE TO LET
4,779 (444 SQ M)



DESCRIPTION

DeVono Cresa are delighted to offer the 3rd floor which provides 4,779 sq.ft of fully fitted high quality office space. The 3rd floor is available by way of an assignment of the existing lease. Alternatively a new lease directly from the landlord may be available.

The available office accommodation comprises of the entire 3rd floor and is arranged in a partially open plan format with 3 meeting rooms and 6 private offices

The existing fit out provides;

- 1 x 12 person boardroom
- 2 x kitchenette
- 3 x meeting rooms
- 6 x private offices
- 24 x open plan work stations
- Cat 6 cabling
- Dedicated reception
- Excellent views of Hyde Park
- Plug & Play setup

AMENITIES

- Manned reception
- 24 hour access
- WCs on each floor
- LG7 lighting
- Raised access floor
- 2 x passenger lift

LOCATION

This commanding development is located at the junction of Curzon Street and Park Lane. Green Park underground station is close by which is served by the Victoria and Jubilee lines. The space is also located a short walk from Hyde Park Corner Station which is served by the Piccadilly Line.

The building is also surrounded by a number of excellent hotels, restaurants and other amenities.

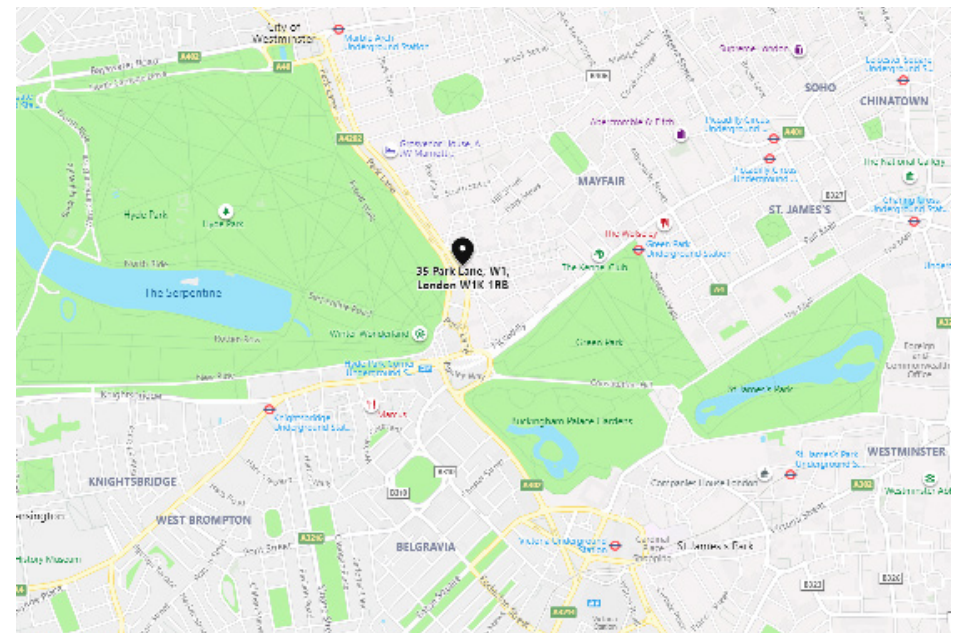

SIZE

Floor	Sq ft	Sq m	Passing Rent (per sq ft)
3rd	4,779	444	£83.15

4,779 SQ FT
(444 SQ M)

INDICATIVE FLOOR PLAN

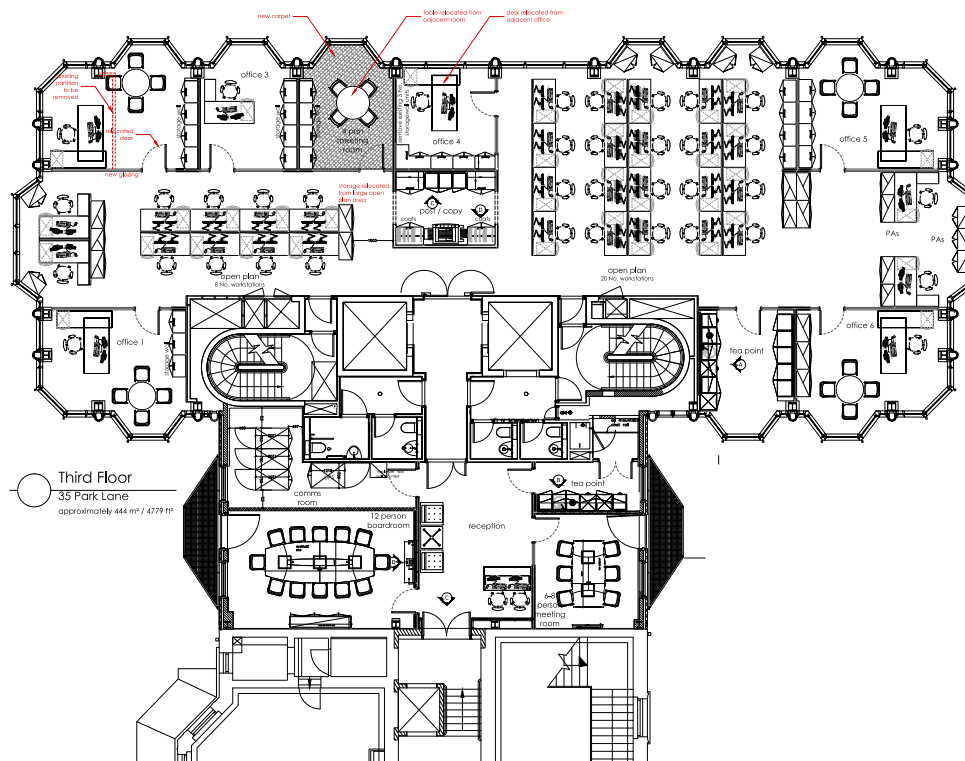

TERMS

Lease: Available by way of an assignment of the current lease expiring June 2023.

Passing Rent: £83.15 per sq ft
Rates: £48.57 per sq ft
Service charge: £19.67 per sq ft

Security of Tenure: Held outside sections 24-28 of the Landlord & Tenant Act 1954 Part II.

EPC

Rating: E

CONTACT

Viewings strictly by appointment with the sole letting agents, DeVono Cresa.

David Barrington

T: 0207 4511 332

M: 07867 950 823

E: db@devonocresa.com

Alex Laws

T: 0207 4511 325

M: 07767 608 304

E: al@devonocresa.com



MISREPRESENTATION ACT

These details are for general guidance only and are not intended to form an offer or part of an offer. All details are given in good faith and are believed to be correct, but any intending purchasers or tenants should not rely on them as statements or representations of fact, but must satisfy themselves by inspection or otherwise as to their correctness. SUBJECT TO CONTRACT

