

SUBLEASE OPPORTUNITY

3333 W. Empire Avenue

Burbank, California

9,133-80,000 SF | Premier Office Campus | 2 Floors | Sub-Divisible

cresa

555 South Flower Street, Suite 4650
Los Angeles, CA 90071

Sub-Divisible Sublease



Prime Opportunity for Media Companies

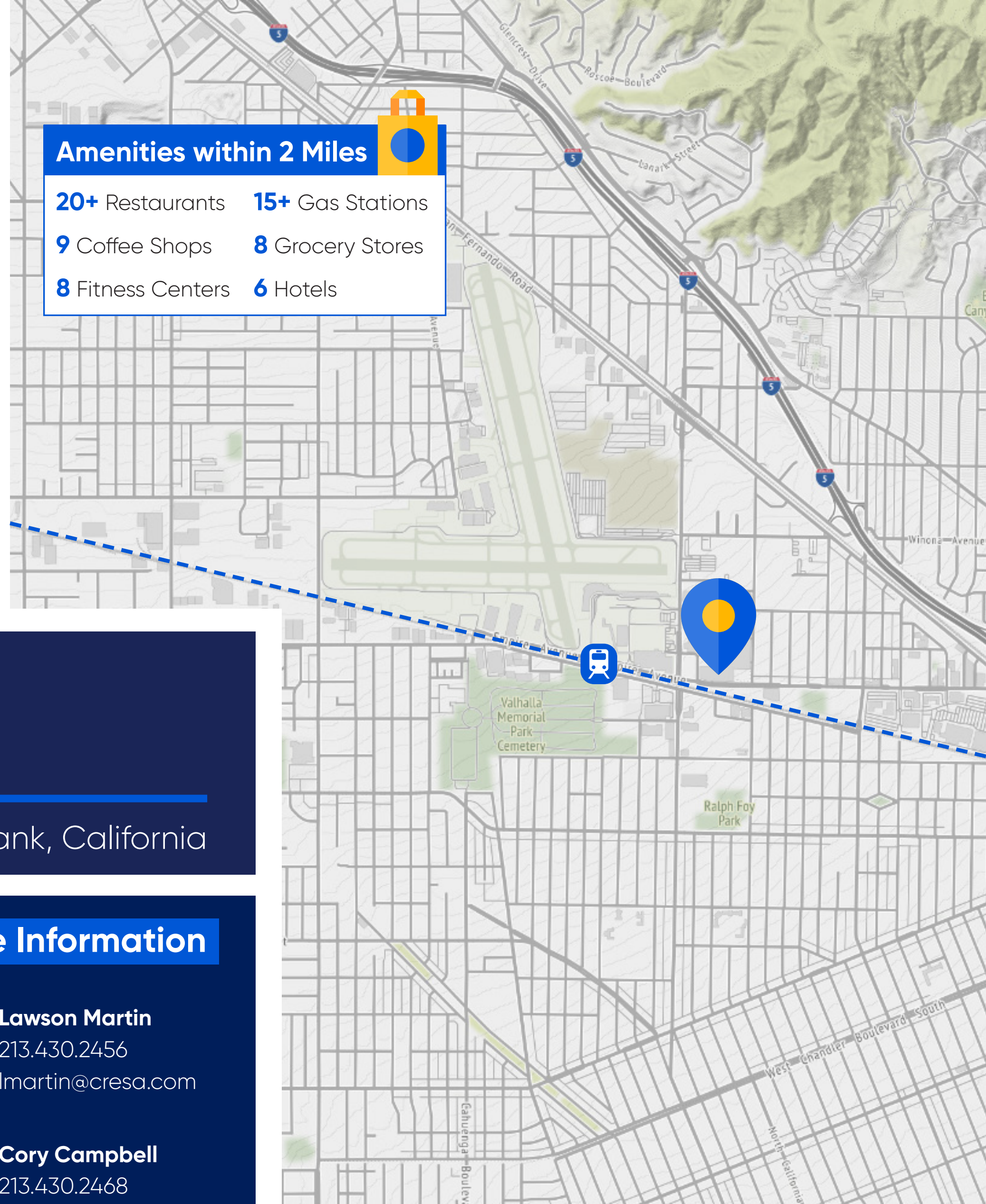

Amenities within 2 Miles



- 20+ Restaurants
- 15+ Gas Stations
- 9 Coffee Shops
- 8 Grocery Stores
- 8 Fitness Centers
- 6 Hotels

3333 W. Empire Avenue

Burbank, California

Space Profile

Building Size	207,885 SF (5 floors)
Typical Floor	39,032 SF
Floors Available	4th & 5th
Sublease Size	9,133-80,000 SF
Rental Rate	\$1.95/SF
Availability	Immediate
Term	Through 1/31/2027
Building Class	A
Built	2005
Parking	3.30/1,000 SF

Features

- Purpose-built edit bays
- Access to outdoor balcony
- Grand reception/town hall space
- Variety of meeting rooms, including a board room
- Mix of open collaboration areas, private offices, and modern workstations
- Premier low-rise office campus within a 19-acre park
- Amenity offerings from Media Studios North includes: a health club facility, volleyball court, putting green, basketball court, day care center, and much more!
- Close proximity to dining, shopping, hotels, the Burbank Airport, Metro Link, and the 5/134 Freeways
- Available sublease space includes 1,927 SF of storage space

For More Information



Lawson Martin
213.430.2456
lmartin@cresa.com



Cory Campbell
213.430.2468
ccampbell@cresa.com

Entire 4th Floor Plan

4th Floor: 39,032 SF

3333 W. Empire Avenue

Burbank, California

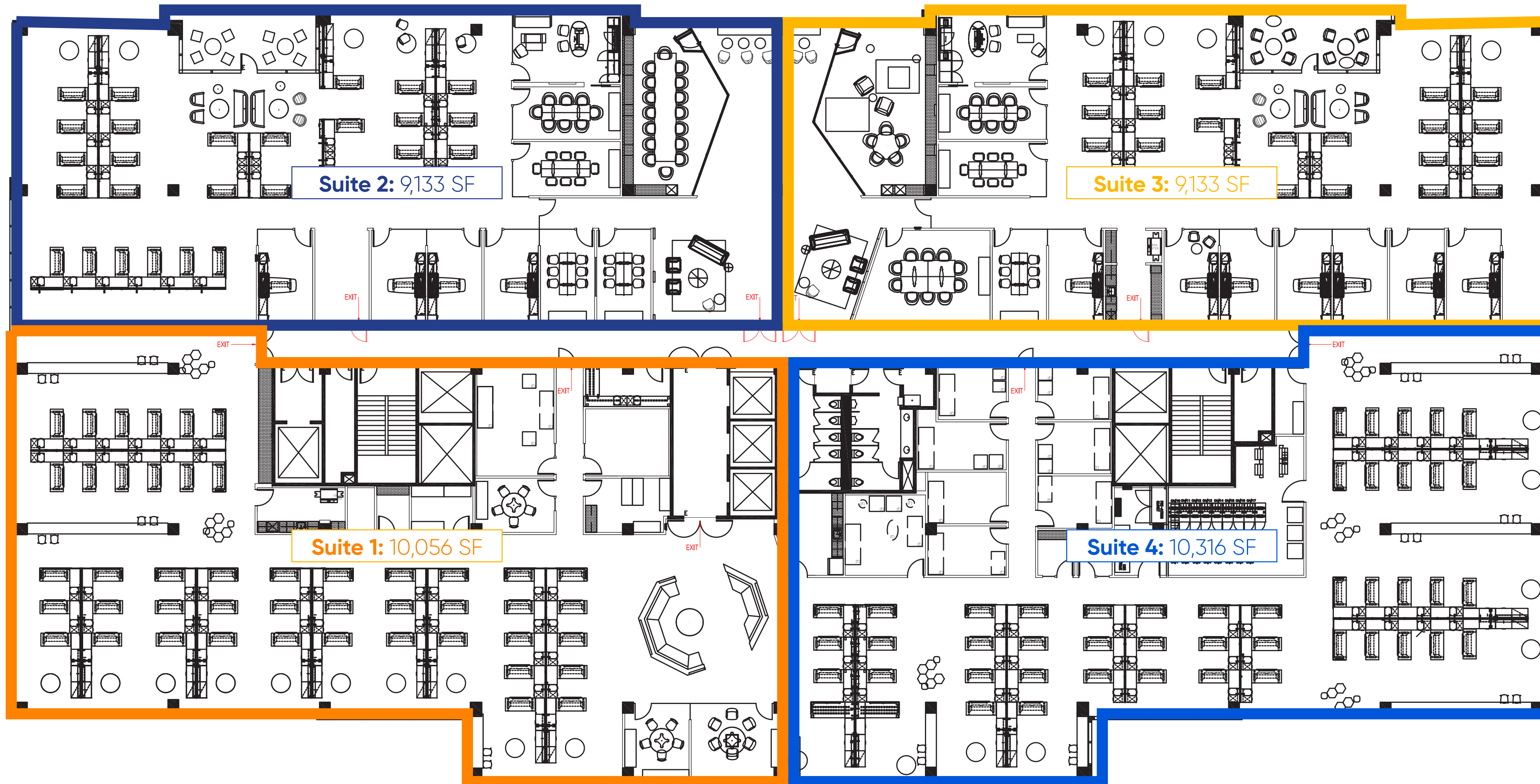

KEY

- Suite 1: 10,056 SF
- Suite 2: 9,133 SF
- Suite 3: 9,133 SF
- Suite 4: 10,316 SF

*Space is not currently demised.
The suites displayed to the left indicate sub-division possibilities.*

Entire 5th Floor Plan

5th Floor: 39,032 SF

3333 W. Empire Avenue

Burbank, California

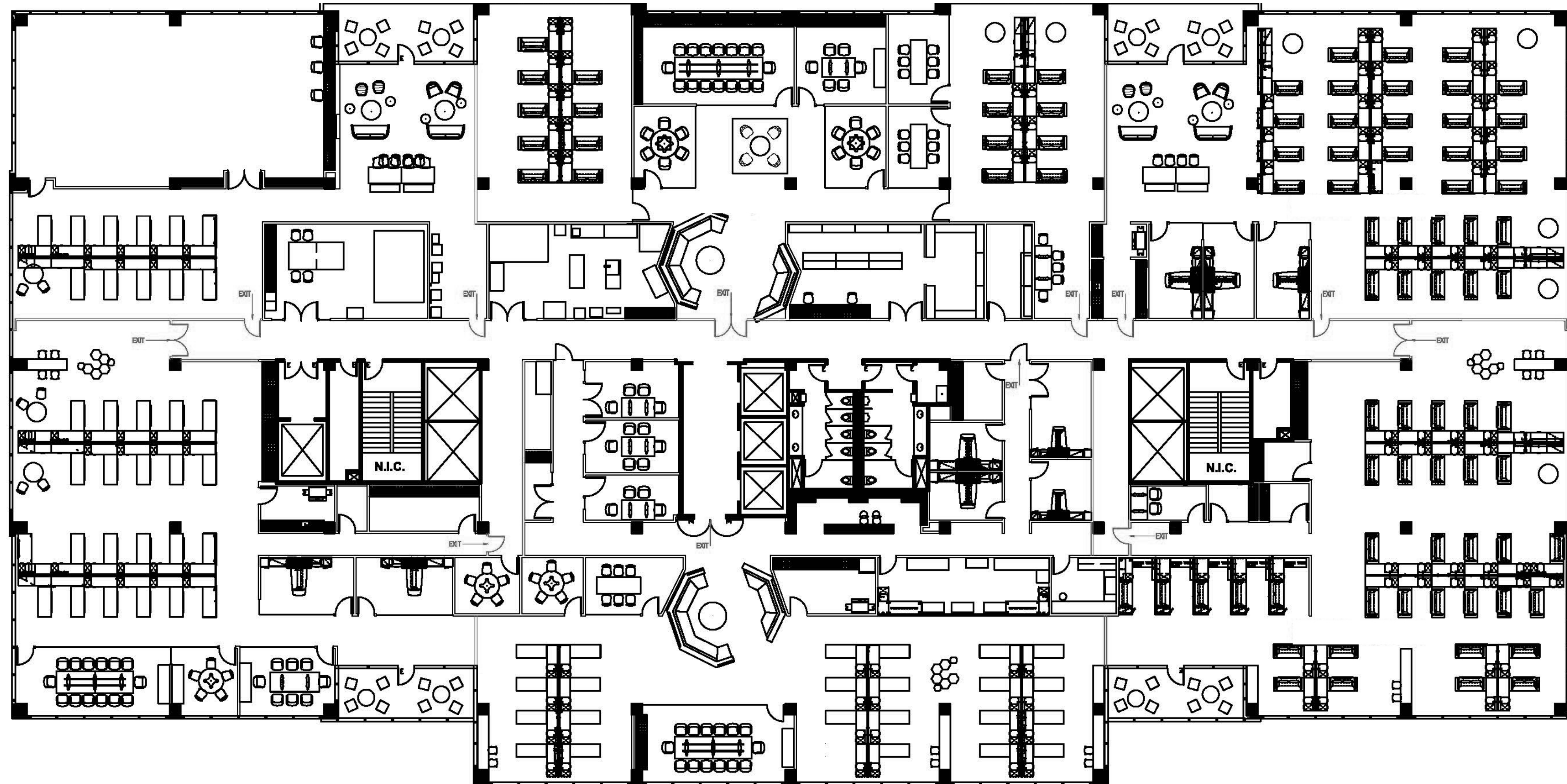

A Feel for the Space



3333 W. Empire Avenue
Burbank, California



SUBLEASE OPPORTUNITY

3333 W. Empire Avenue

Burbank, California

Even though obtained from sources deemed reliable, no warranty or representation, express or implied, is made as to the accuracy of the information herein, and it is subject to errors, omissions, change of price, rental or other conditions, withdrawal without notice, and to any special listing conditions imposed by our principals.

For More Information



Lawson Martin
213.430.2456
lmartin@cresa.com



Cory Campbell
213.430.2468
ccampbell@cresa.com

cresa

555 South Flower Street, Suite 4650
Los Angeles, CA 90071