



**2700 Colorado Avenue
Santa Monica, CA**

**Sublease
Available**

Space Profile

Premises	39,374 SF (2nd Floor)
Rental Rate	\$5.00 PSF, FSG
Availability	Immediately
Term	Through August 31, 2025
Parking	3.5 per 1,000 SF More available as needed

Features

Dynamic, Creative Office Space

- Gensler Designed Office-With overstandard finishes and furnishings
- Ample Floor Space-Good Traffic flow/Social Distancing
- Prime Location-26th Street Entertainment Corridor
- 88 Walk Score: Endless amenities and Bergamot Metro Station within walking distance
- Tiato Restaurant-Serving the building with indoor and outdoor dining/meeting areas and catering services



For More Information

Lawson Martin
213.430.2456 direct
lmartin@cresa.com
BRE# 00773991

James Travers
213.430.2441 direct
jtravers@cresa.com
BRE# 00478795

515 South Flower Street, Suite 3000, Los Angeles, CA 90071



Even though obtained from sources deemed reliable, no warranty or representation, express or implied, is made as to the accuracy of the information herein, and it is subject to errors, omissions, change of price, rental or other conditions, withdrawal without notice, and to any special listing conditions imposed by our principals.



2700 Colorado Avenue
Santa Monica, CA

2nd Floor - 39,374 SF

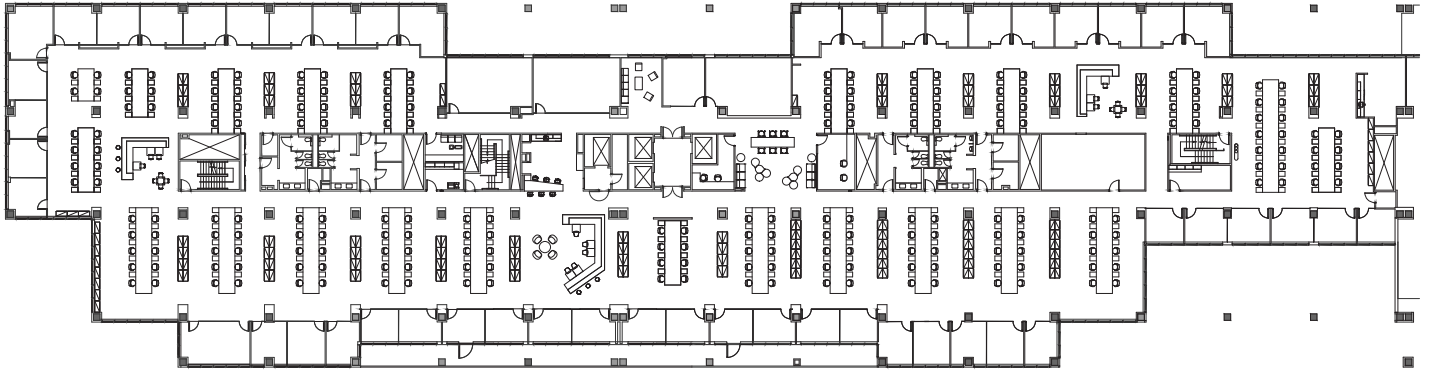

46 Offices/170 Workstations
(216 Total Seats)

Interior Photos



Pantry



Conferring Area with Attached Pantry

For More Information

Lawson Martin
213.430.2456 direct
lmartin@cresa.com
BRE# 00773991

James Travers
213.430.2441 direct
jtravers@cresa.com
BRE# 00478795

Interior Photos



For More Information

Lawson Martin
213.430.2456 direct
lmartin@cresa.com
BRE# 00773991

James Travers
213.430.2441 direct
jtravers@cresa.com
BRE# 00478795