

For Sale



Jurupa Valley Business Park

Jurupa Valley, CA 91752

10513 San Sevaine Way

Office SF	688
Mezzanine SF	895
Total Building Area	10,864 SF
Loading	One (1) 12'x12' door
Parking	22 spaces

10567 San Sevaine Way

Office SF	744
Mezzanine SF	929
Total Building Area	10,212 SF
Loading	One (1) 12'x12' door
Parking	20 spaces

Asking Price: Upon Request

Features

- Two (2) adjacent buildings totaling 21,067 SF
- 22' clear height
- Built in 2007
- Minutes to the 15 and 60 Freeways
- Both buildings are owned and occupied by Plastic Innovations, who will execute a sale/leaseback to commence upon Close of Escrow at terms to be mutually agreed upon between Buyer and Seller.

For More Information

Griffin Farriss

Stream Realty Partners
561.676.2601 direct
griffin.farriss@streamrealty.com
BRE# 01939767

James Friedrich

Cresa
213.430.2449 direct
jfriedrich@cresa.com
BRE# 01919846

For Sale

Jurupa Valley Business Park

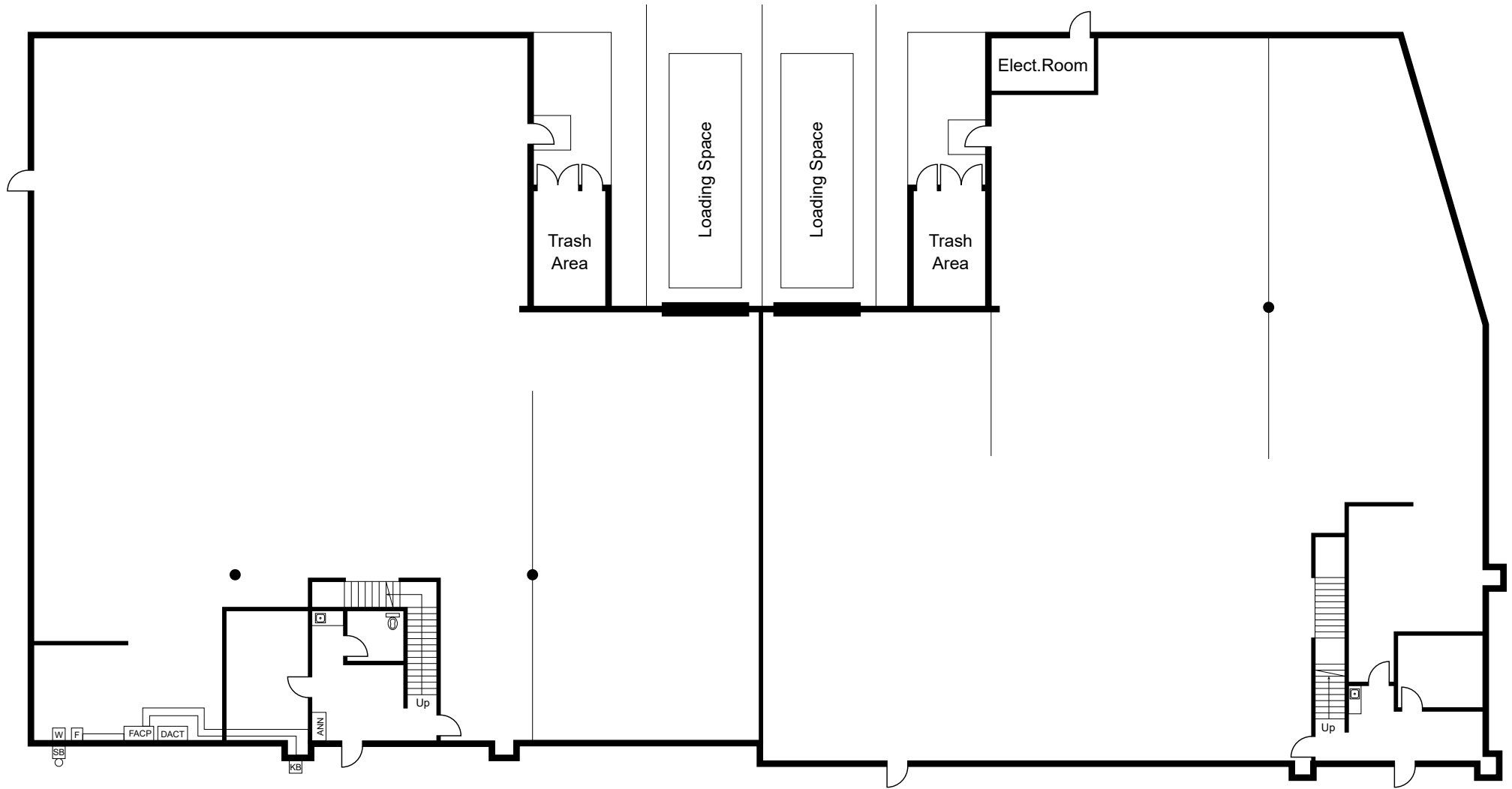

For More Information

Griffin Farriss

Stream Realty Partners

561.676.2601 direct | griffin.farriss@streamrealty.com
BRE# 01939767

James Friedrich

Cresa

213.430.2449 direct | jfriedrich@cresa.com
BRE# 01919846



For Sale

Jurupa Valley Business Park

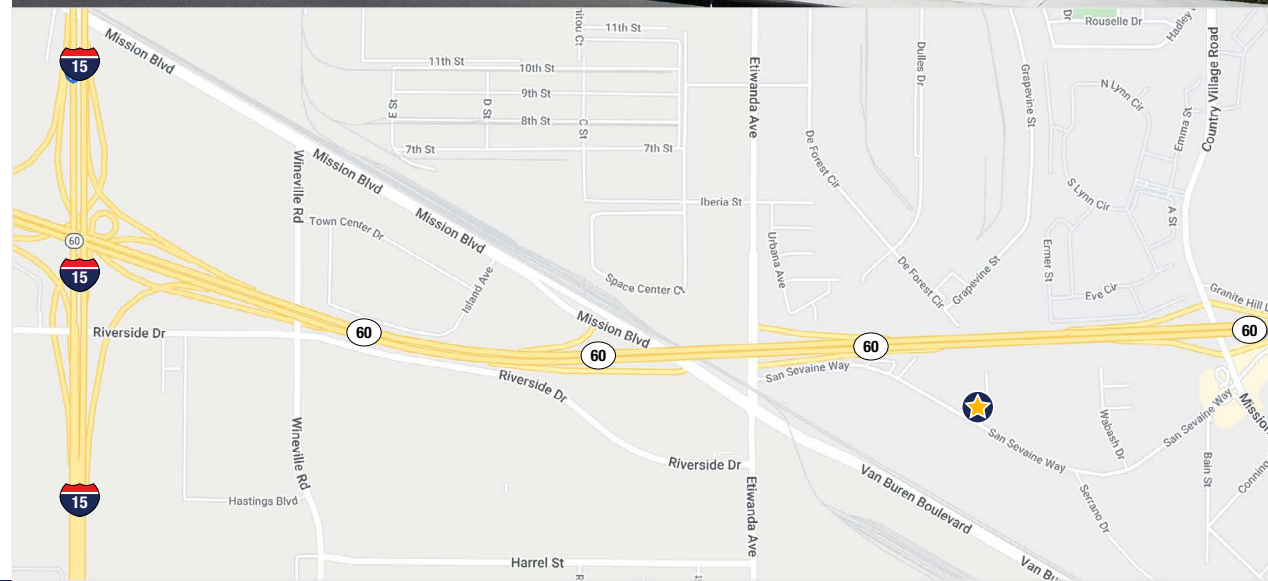
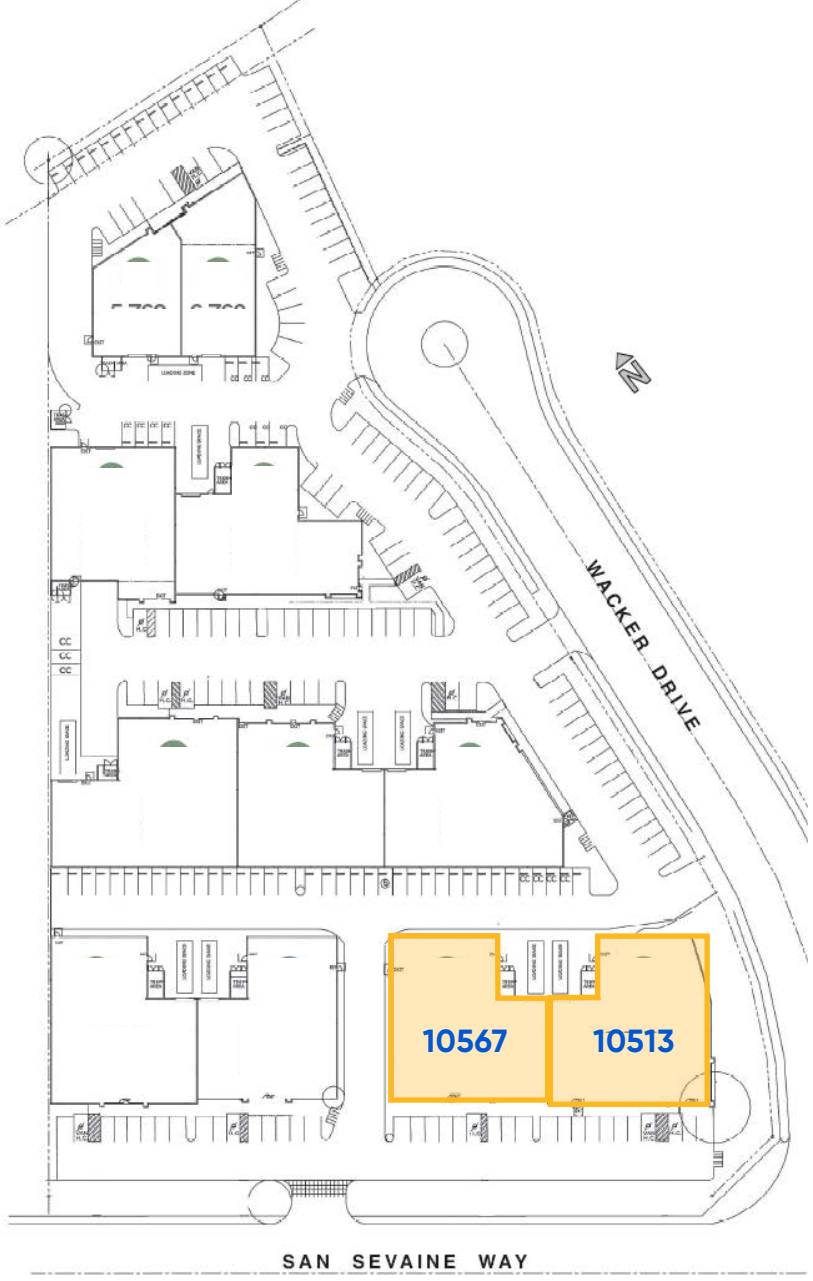

For More Information

Griffin Farriss

Stream Realty Partners

561.676.2601 direct | griffin.farriss@streamrealty.com
BRE# 01939767

James Friedrich

Cresa

213.430.2449 direct | jfriedrich@cresa.com
BRE# 01919846



Even though obtained from sources deemed reliable, no warranty or representation, express or implied, is made as to the accuracy of the information herein, and it is subject to errors, omissions, change of price, rental or other conditions, withdrawal without notice, and to any special listing conditions imposed by our principals.