



Sun Life Place

2,999 sf Sub-Sublease

Photo Credit: CoStar Group

Todd Walker
780.952.8331
twalker@cresa.com

Byron Wakeling
780.993.2367
bwakeling@cresa.com



Sun Life Place



**2,999 sf available
immediately**

Space Profile

Sub-Sublandlord:	Glen Cowan & Associates Real Property Appraisals Ltd.
Sub-Subpremises:	Suite 1090: 2,999 sf
Availability:	Immediately
Term Expiry:	June 29, 2024
Rental Rate:	\$3.00 per sf
Subtenant Inducement:	Negotiable
Op. Costs & Taxes:	\$18.57 per sf (est. 2023)
Parking:	3 parking stalls at \$315.00 per stall per month

Building Information

Address:	10123 - 99 Street NW
Year of Completion:	1978
Number of Floors:	25
Rentable Area:	289,419 sf
Average Floor plate:	11,426 sf
Security:	7 days per week, 24 hours per day Manned security desk, card key access
HVAC:	7:00 am - 6:00 pm (Excluding holidays)
Landlord/ Building Manager:	Slate Asset Management

Features & Amenities

High quality, built out office space with sliding glass doors and plenty of natural light

Amazing views of the Edmonton River Valley

Within walking distance to several public transit routes

Downtown interior pedway system accessible directly across the street

Building has newly completed contemporary amenities such as various sized board rooms and fully equipped fitness facility

Located in the downtown core with various restaurants and shopping malls within walking distance

24/7 on-site security within the building

10th Floor 2,999 sf

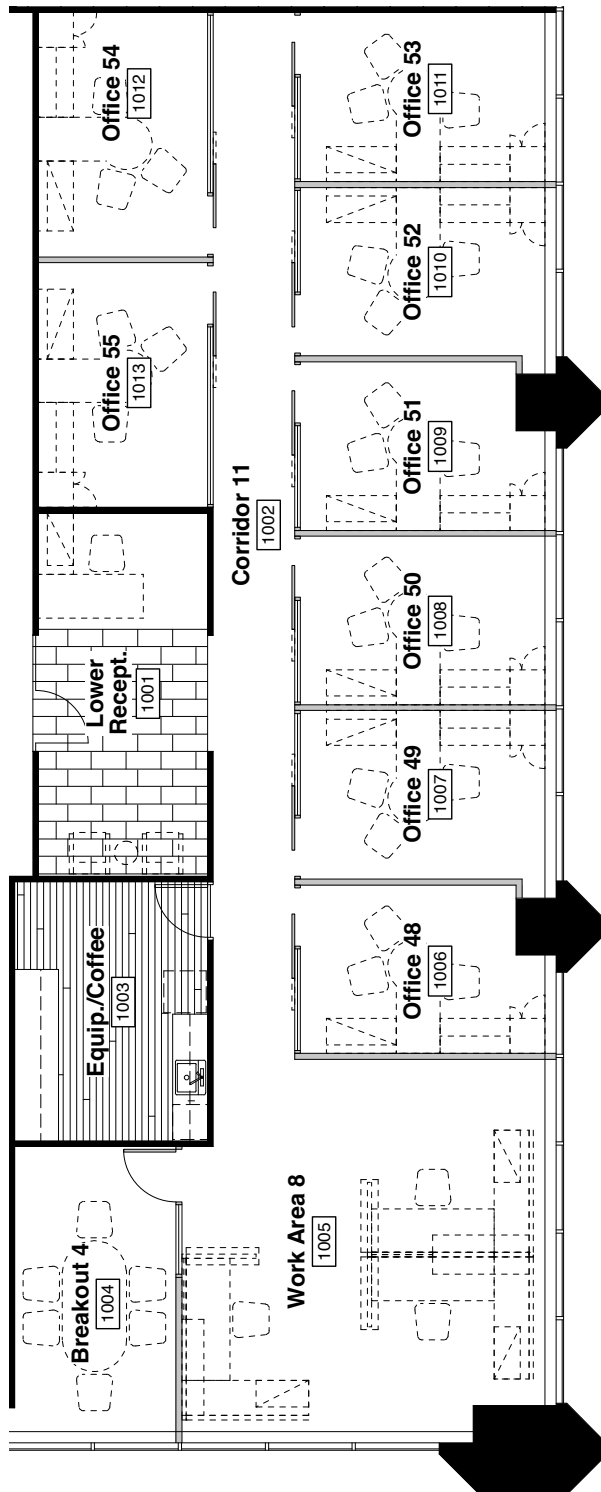

- 6 perimeter offices
- 2 interior offices
- Open area for workstations
- Reception
- Breakout room
- Kitchen/copy room

Sun Life Place



Bright space with abundance of natural light

High quality, built out office space with sliding glass doors and furniture available.



Well-appointed collaboration and staff areas

Building has newly completed contemporary amenities such as various sized board rooms and fully equipped fitness facility.



Suite 1090 | 2,999 sf

cresa

Sun Life Place



10123 - 99 Street NW



Agent Information

Todd Walker
780.952.8331
twalker@cresa.com

Byron Wakeling
780.993.2367
bwakeling@cresa.com

Cresa

10020 - 101A Avenue, Suite 1980 | Edmonton, AB T5J 3G2 | 780.900.8781 | cresa.com

Even though obtained from sources deemed reliable, no warranty or representation, express or implied, is made as to the accuracy of the information herein, and it is subject to errors, omissions, change of price, rental or other conditions, withdrawal without notice, and to any special listing conditions imposed by our principals.

