

Plug & Play Big Block Available

2101 Webster Street
Oakland, CA

Space Profile:

Premises	18th Floor & 19th Floor Can be leased together or separately
RSF	18th Floor - 24,467 RSF 19th Floor - 24,467 RSF Total: 48,934 RSF
Rental Rate	Below market Call to inquire
Availability	Flexible
Term	Thru June 2025



Features:

- Two full floor opportunities with internal staircase
- Can sublease together or separately
- Dedicated double door entrance
- Fully wired, access to wifi, plug-n-play, several conference room tables and chairs
- Move-in ready
- Credit Sublessor
- Spectacular views of Lake Merritt and San Francisco Bay
- New construction, excellent natural light, three sides of glass
- Open plan with team rooms, offices, creative/collaborative kitchen
- Close proximity to BART

Contact for more information or tour:

Scott Stone
510.593.4002
sstone@cresa.com
BRE#01230051

Brandon Leitner
415.394.1048
bleitner@cresa.com
BRE#02001670

Stephen Carlson
510.381.9901
scarlson@cresa.com
BRE#01839414



2101 Webster Street
18th Floor
Oakland, CA

Contact:

Scott Stone

510.593.4002
 sstone@cresa.com
 BRE#01230051

Brandon Leitner

415.394.1048
 bleitner@cresa.com
 BRE#02001670

Stephen Carlson

510.381.9901
 scarlson@cresa.com
 BRE#01839414

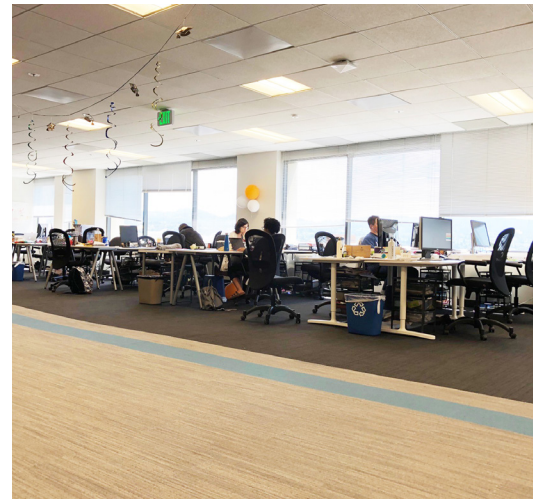

cresa

Cresa © 2020. All rights reserved. The information contained in this document has been obtained from sources believed reliable. While Cresa does not doubt its accuracy, Cresa has not verified it and makes no guarantee, warranty, or representation about it. It is your responsibility to independently confirm its accuracy and completeness. Any projections, opinions, assumptions or estimates used are for example only and do not represent the current or future performance of the property. The value of this transaction to you depends on tax and other factors which should be evaluated by your tax, financial and legal advisors. You and your advisors should conduct a careful, independent investigation of the property to determine to your satisfaction the suitability of the property for your needs.



2101 Webster Street
19th Floor
Oakland, CA

Contact:

Scott Stone

510.593.4002
 sstone@cresa.com
 BRE#01230051

Brandon Leitner

415.394.1048
 bleitner@cresa.com
 BRE#02001670

Stephen Carlson

510.381.9901
 scarlson@cresa.com
 BRE#01839414

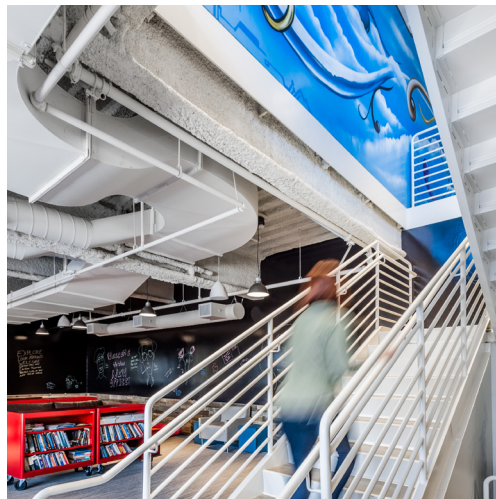

Photos by: GeorgeXLin

cresa

Cresa © 2020. All rights reserved. The information contained in this document has been obtained from sources believed reliable. While Cresa does not doubt its accuracy, Cresa has not verified it and makes no guarantee, warranty, or representation about it. It is your responsibility to independently confirm its accuracy and completeness. Any projections, opinions, assumptions or estimates used are for example only and do not represent the current or future performance of the property. The value of this transaction to you depends on tax and other factors which should be evaluated by your tax, financial and legal advisors. You and your advisors should conduct a careful, independent investigation of the property to determine to your satisfaction the suitability of the property for your needs.

2101 Webster Street

Oakland, CA

18th Floor

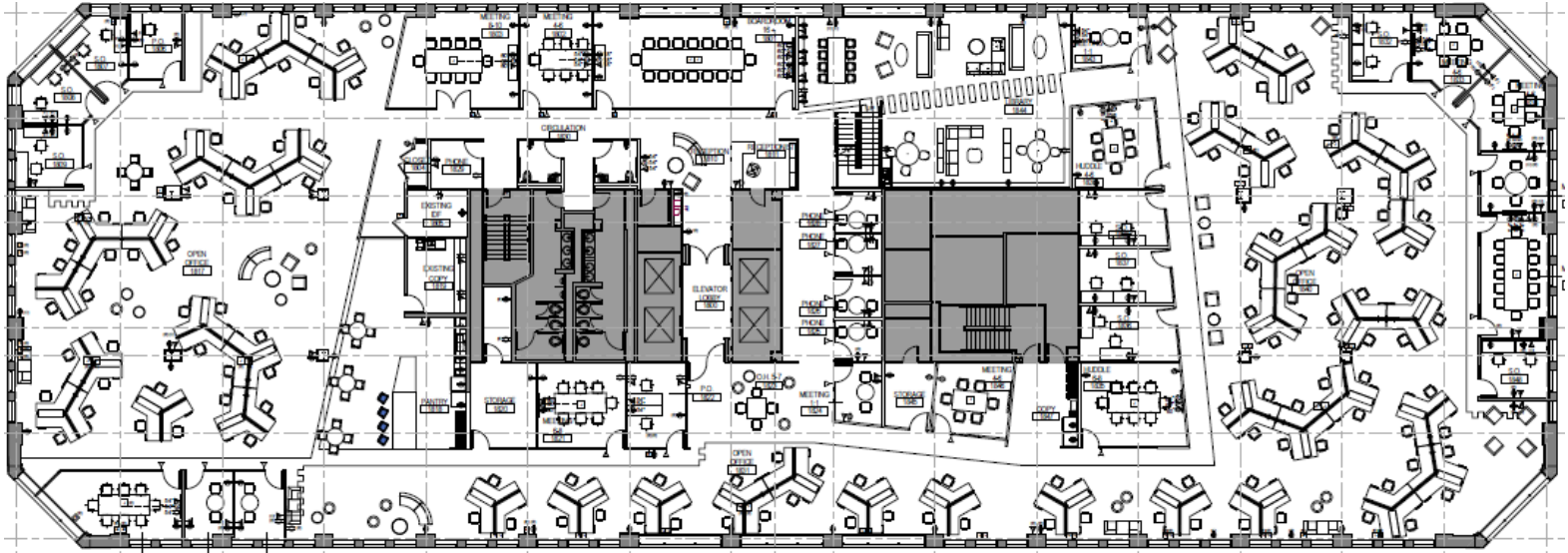

19th Floor

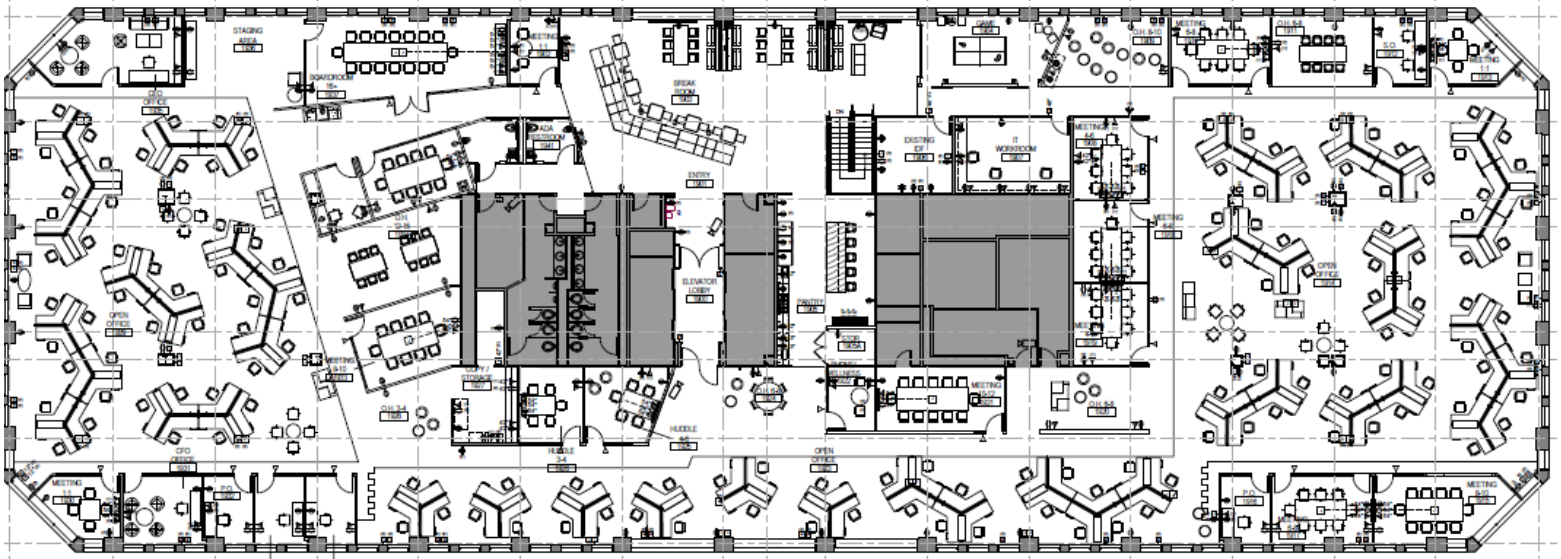

Cresa © 2020. All rights reserved. The information contained in this document has been obtained from sources believed reliable. While Cresa does not doubt its accuracy, Cresa has not verified it and makes no guarantee, warranty, or representation about it. It is your responsibility to independently confirm its accuracy and completeness. Any projections, opinions, assumptions or estimates used are for example only and do not represent the current or future performance of the property. The value of this transaction to you depends on tax and other factors which should be evaluated by your tax, financial and legal advisors. You and your advisors should conduct a careful, independent investigation of the property to determine to your satisfaction the suitability of the property for your needs.

Wellness Check-in

Please answer the following questions

- Have you been confirmed positive for COVID-19?
- Are your currently experiences, or recently experienced, any acute respiratory illness symptoms such as fever, cough, or shortness of breath?
- Have you been in close contact with any persons who have been confirmed positive for COVID-19?
- Have you been in close contact with any persons who have traveled and are also exhibiting acute respiratory illness symptoms?

COVID-19 Prevention Plan

Guidelines for Property Tours

If you are sick with COVID-19, have symptoms consistent with COVID-19, or have been in close contact with someone who has COVID-19, it is important to stay home and away from other people until it is safe to be around others. Cresa has adopted the following best practices based on the most recent National and County recommendations.



Physical Distancing

- Limit the number of visitors and maintain a minimum of six feet between yourself and others at all times, including elevators and building common areas
- Keep doorways open to avoid unnecessary contact with surfaces
- Refrain from passing pens, paperwork, keys and touching knobs, handles, switches, pulls, counters, desks, windows, etc.
- Utilize virtual tours whenever possible. If virtual tours are not possible, marketing materials should be delivered electronically to avoid handling paper
- Avoid greetings that break physical distancing



PPE (Personal Protective Equipment)

- Upon entering, make sure hands are washed with soap and water or use hand sanitizer immediately
- All visitors require face coverings as required per local health ordinance



Cleaning

- Clean and disinfect commonly used surfaces before and after each showing
- Introduce fresh air where possible
- Equip properties with sanitizing products for hands and surfaces
- Arrange tours at least one business day in advance to facilitate disinfection and cleaning



Additional Guidelines

- By entering occupied space, all visitors agree to comply with current tenant's protocols for entering their space, which may include:
 - Wearing PPE (Personal Protective Equipment)
 - Temperature Checks
 - Physical Distancing