

# Sublease Available

## *High Profile Space*

1603 Orrington Ave  
Evanston, IL

### Space Profile

<b>Premises</b>	12th Floor - Suite 1200
<b>RSF</b>	9,027 RSF
<b>Rental Rate</b>	Negotiable
<b>Availability</b>	Immediate
<b>Term</b>	Until 7/31/2026
<b>Building Class</b>	A
<b>Submarket</b>	Near North
<b>Built</b>	Renovated in 1999
<b>Parking</b>	340 Covered Spaces are available; .84/1,000 SF

### Features

- All furniture available
- Dramatic views
- High-End build out
- Mix of window-line and internal offices
- Elevator Identity

### For More Information



**Jason Kleiman**  
312.376.4132  
jkleiman@cresa.com



**Sean Murphy**  
312.376.4125  
smurphy@cresa.com

Even though obtained from sources deemed reliable, no warranty or representation, express or implied, is made as to the accuracy of the information herein, and it is subject to errors, omissions, change of price, rental or other conditions, withdrawal without notice, and to any special listing conditions imposed by our principals.



150 N Wacker Drive, Suite 2900, Chicago, IL 60606



1603 Orrington Ave  
Evanston, IL

Suite 1200 - 9,027 SF

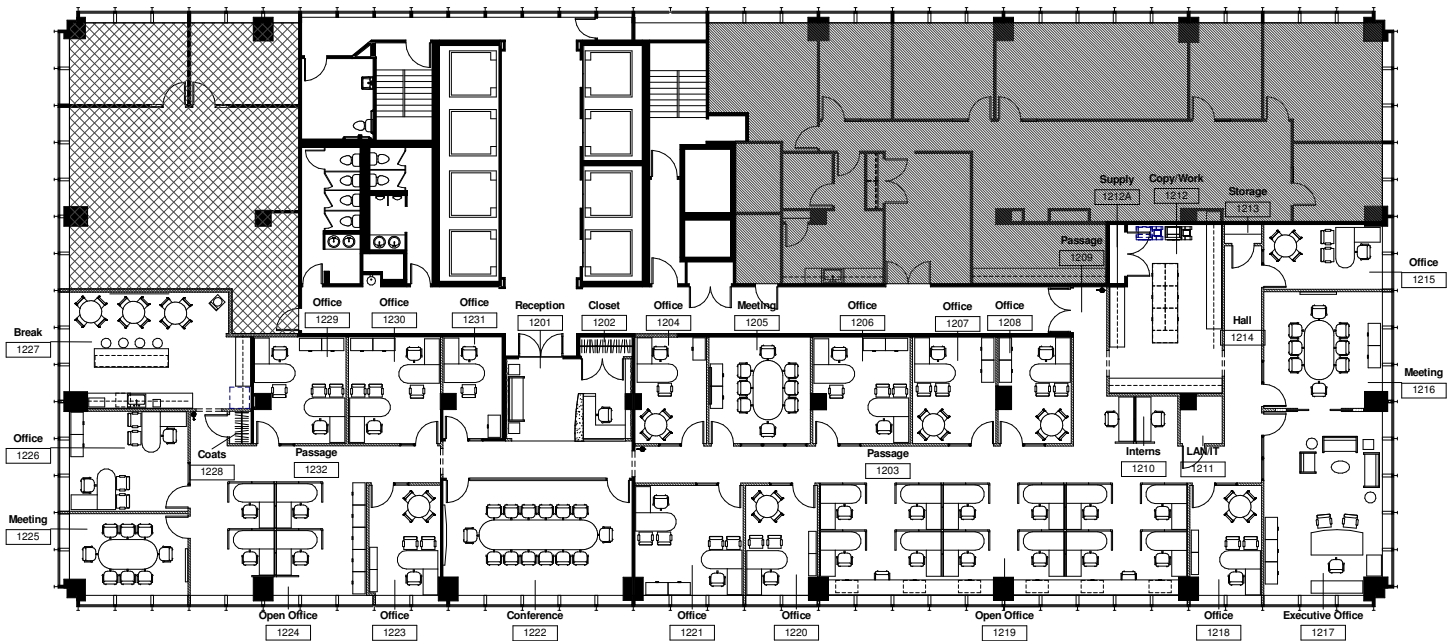

1603 Orrington Avenue, Suite 1200 Evanston, Illinois

## For More Information

**Cresa**  
150 N Wacker Drive  
Suite 2900  
Chicago, IL 60606  
[cresa.com/chicago](http://cresa.com/chicago)



**Jason Kleiman**  
312.376.4132  
[jkleiman@cresa.com](mailto:jkleiman@cresa.com)



**Sean Murphy**  
312.376.4125  
[smurphy@cresa.com](mailto:smurphy@cresa.com)



**1603 Orrington Ave  
Evanston, IL**

**Suite 1200 - 9,027 SF**



## For More Information

**Jason Kleiman**  
312.376.4132  
[jkleiman@cresa.com](mailto:jkleiman@cresa.com)

**Sean Murphy**  
312.376.4125  
[smurphy@cresa.com](mailto:smurphy@cresa.com)