

Sublease



Space Profile:

Floors	12-14
Size	8,257 - 16,132 SF
Rental Rate	Negotiable
Availability	Immediate
Term	Floor 12 through 9/30/2024 Floor 13/14 through 9/30/2025
Submarket	Financial District
Built	1927, Renovated 1988
Parking	None

Features:

- Plug-and-play space
- Open layout
- Prominent Downtown Crossing location, offering a mix of amenities
- Superior access to public transit
- Building boasts lobby improvements, floor plates with great natural light, and a boutique fitness center

For More Information



Derek Losi
617.758.6021
dlosi@cresa.com



Andrew Orpik
617.758.6077
aorpik@cresa.com

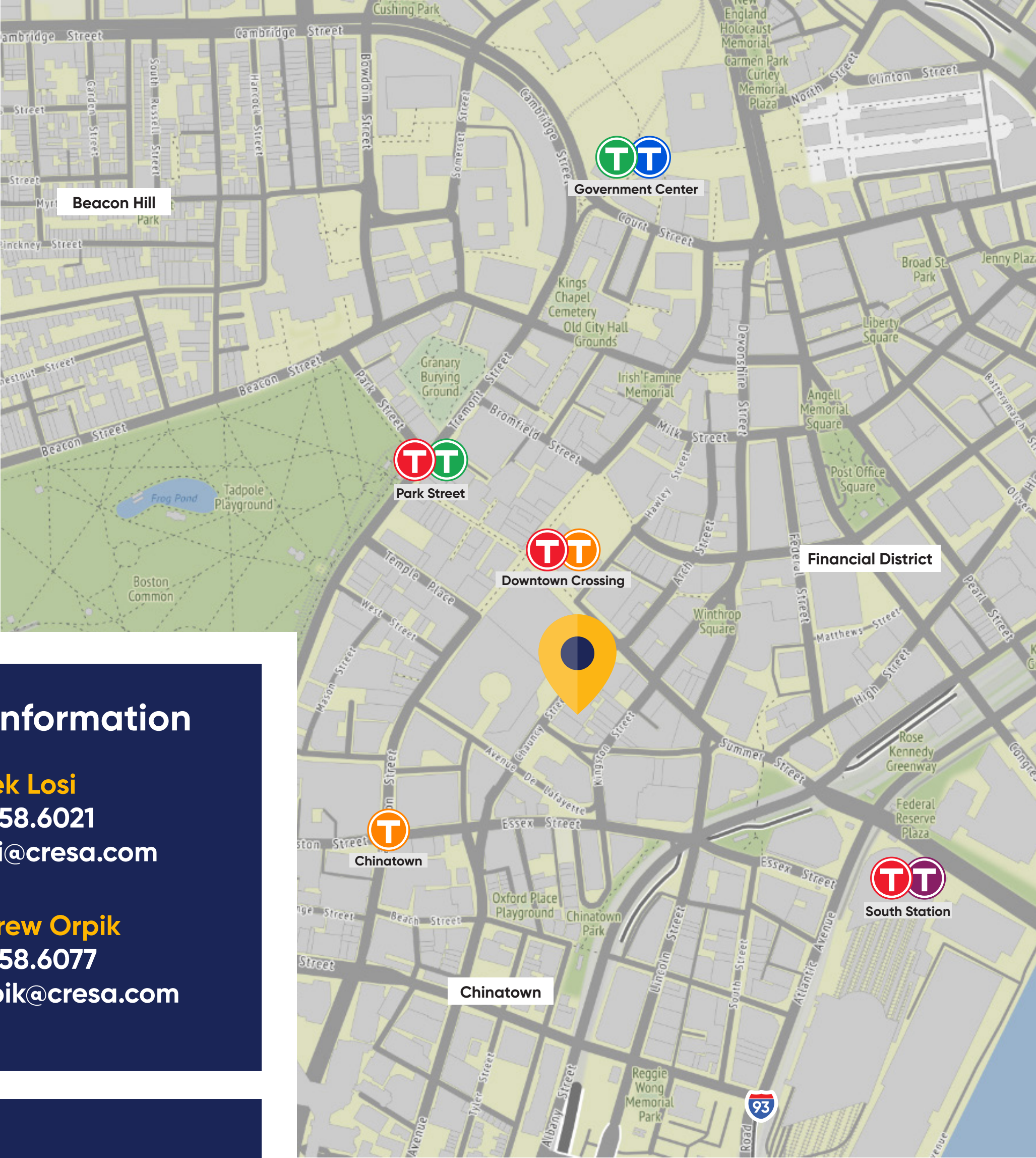

38 Chauncy Street

Boston, Massachusetts



WATCH THE
VIRTUAL TOUR

cresa

280 Congress Street, Floor 10
Boston, MA 02210

The Space



38 Chauncy Street

Boston, Massachusetts

Floor Plan

Floor 12: 8,257 SF

Seat Count Floor 12: 50 bench workstations in-place, with space and systems to accommodate 80-100

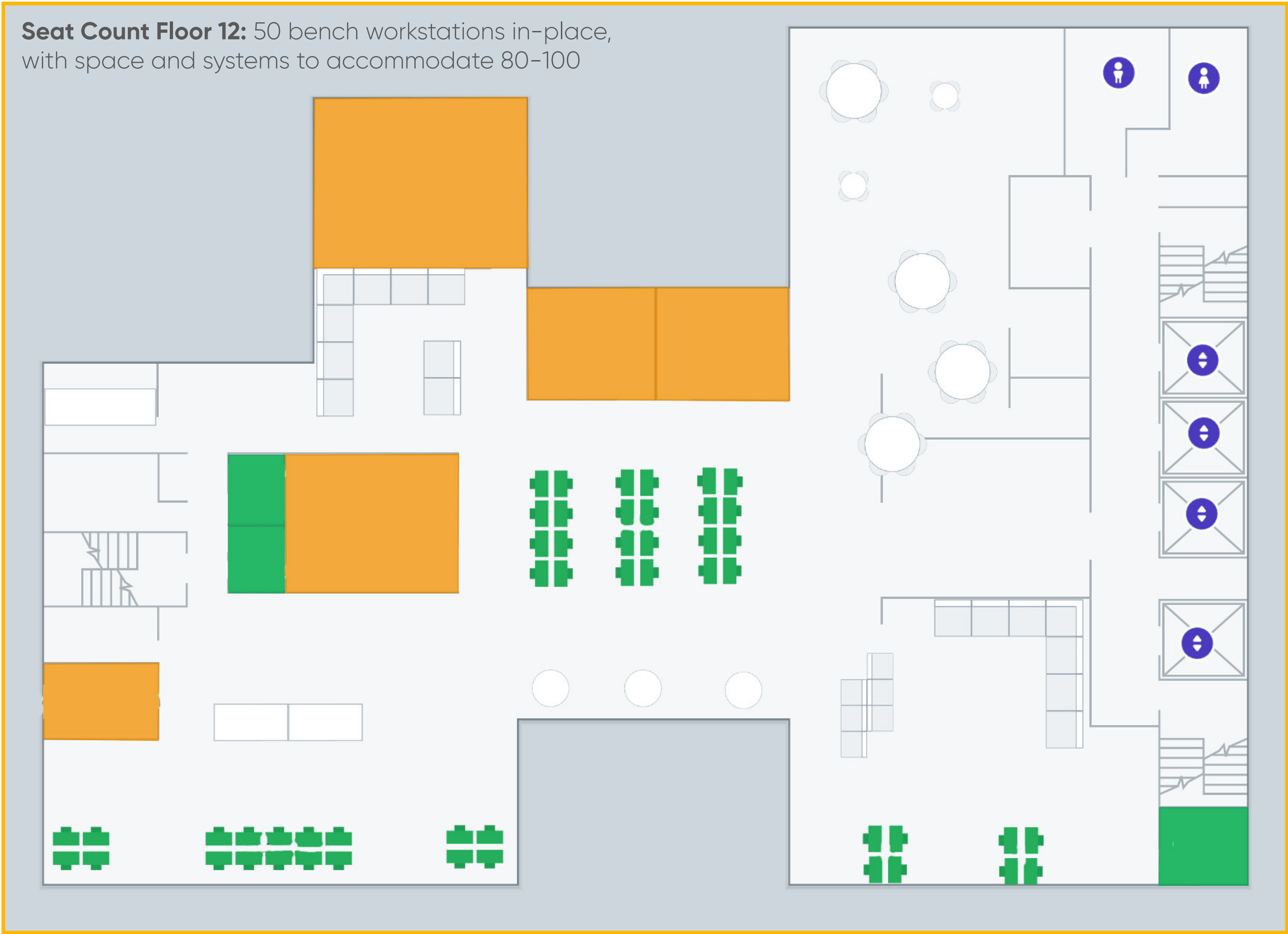

38 Chauncy Street

Boston, Massachusetts



Even though obtained from sources deemed reliable, no warranty or representation, express or implied, is made as to the accuracy of the information herein, and it is subject to errors, omissions, change of price, rental or other conditions, withdrawal without notice, and to any special listing conditions imposed by our principals.

cresa