

Sublease Atlantic Station

201 17th St NW
Atlanta, GA 30363

Features:

- 2 Full Floors Available; Divisible by Floor
- Fantastic Views From All Sides
- Furnished/Move In Ready
- On-site training and conferences rooms - free of charge
- Bike storage/showers, and cafe
- Multiple restaurants, retail stores, a movie theater, and a hotel within walking distance
- Shuttle to MARTA Arts Station 20 hours each day

Space Profile:

Premises	7th and 11th Floors	Building Class	A
RSF	43,364 RSF Divisible to 21,682 RSF	Submarket	Midtown
Rental Rate	\$36.00/RSF FSG	Year Built	2007
Availability	Immediate	Term	Thru 3/15/2027
		Parking Ratio	4.3/1,000 SF

Contact:



Billy Hobbs
404.446.1579
bhobbs@cresa.com



Bubba Chrismer
404.446.1574
bchrismer@cresa.com



Atlantic Station

207 17th St NW

Contact:



Billy Hobbs
404.446.1579
bhobbs@cresa.com



Bubba Chrismer
404.446.1574
bchrismer@cresa.com



cresa ::

Cresa © 2019. All rights reserved. The information contained in this document has been obtained from sources believed reliable. While Cresa does not doubt its accuracy, Cresa has not verified it and makes no guarantee, warranty, or representation about it. It is your responsibility to independently confirm its accuracy and completeness. Any projections, opinions, assumptions or estimates used are for example only and do not represent the current or future performance of the property. The value of this transaction to you depends on tax and other factors which should be evaluated by your tax, financial and legal advisors. You and your advisors should conduct a careful, independent investigation of the property to determine to your satisfaction the suitability of the property for your needs.



Atlantic Station

207 17th St NW

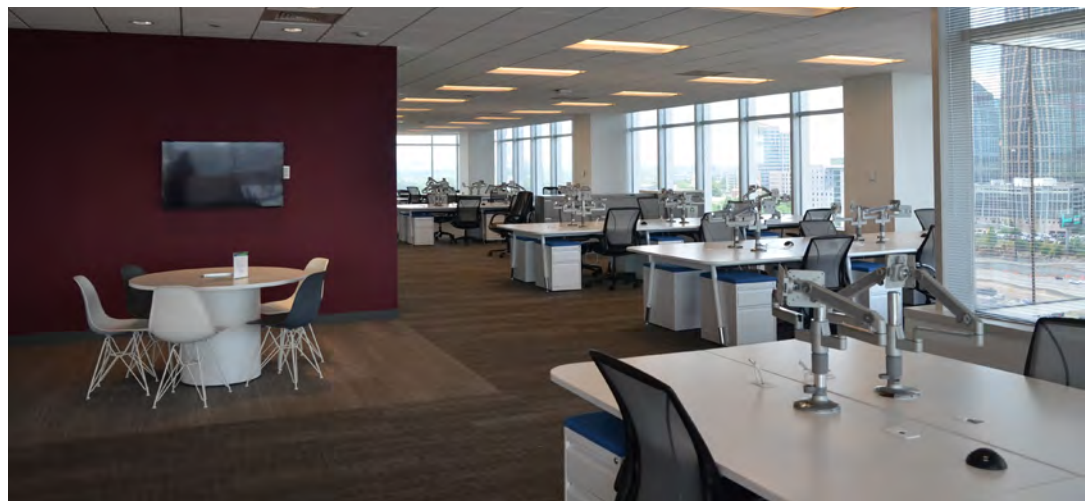

cresa

Cresa © 2019. All rights reserved. The information contained in this document has been obtained from sources believed reliable. While Cresa does not doubt its accuracy, Cresa has not verified it and makes no guarantee, warranty, or representation about it. It is your responsibility to independently confirm its accuracy and completeness. Any projections, opinions, assumptions or estimates used are for example only and do not represent the current or future performance of the property. The value of this transaction to you depends on tax and other factors which should be evaluated by your tax, financial and legal advisors. You and your advisors should conduct a careful, independent investigation of the property to determine to your satisfaction the suitability of the property for your needs.

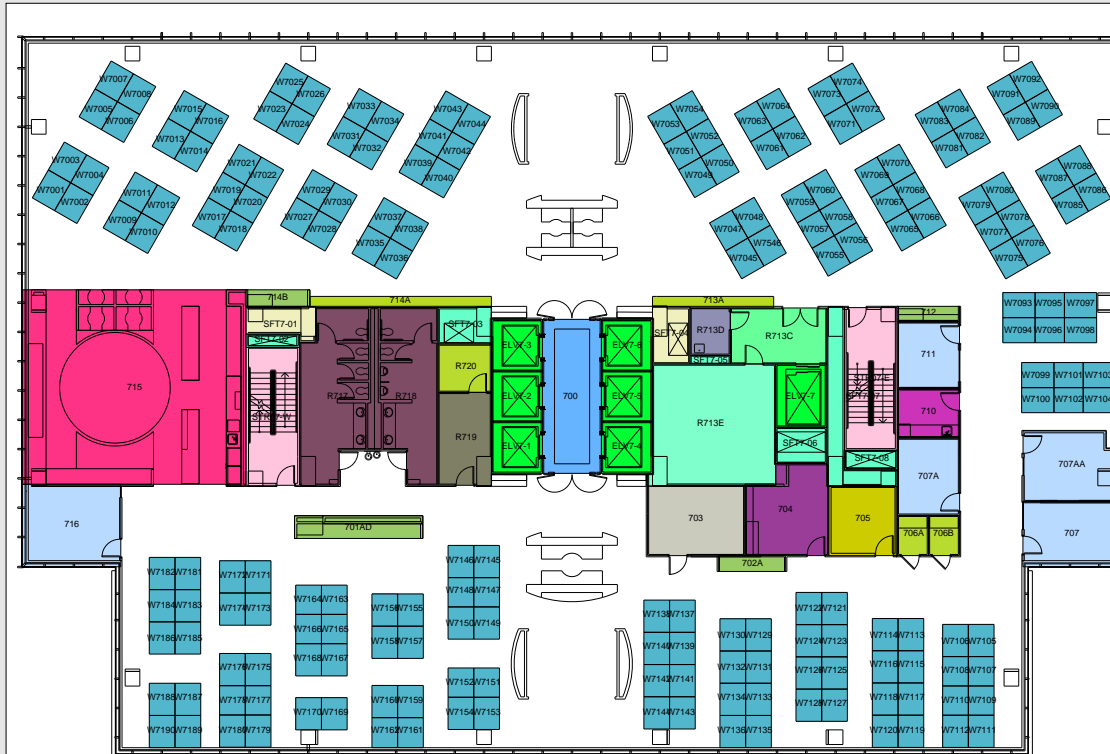

Powered by Archibus

Room Category	Room Type	Legend	Area
PERS	OFFICE		437.67
PERS	WRKS		4,500.07
PROD	HUDDLE		881.64
PROD	PRINT		203.97
SERV	COLLAB		139.27
SERV	COPY		176.79
SERV	CORRIDOR		157.45
SERV	ELECTRICAL		145.44
SERV	FILES		97.86
SERV	IDF MDF		199.33
SERV	JANITORIAL		55.94
SERV	LOBBY		264.43
SERV	LOUNGE		1,268.46
SERV	MOTHERS RM		89.18
SERV	RESTROOM		631.23
SERV	SHAFT		120.86
SERV	TELEPHONE		148.49
VERT	ELEVATOR		551.88
VERT	SHAFT		288.59
VERT	STAIR		434.65

7th Floor Total:
21,682 RSF
190 Seats

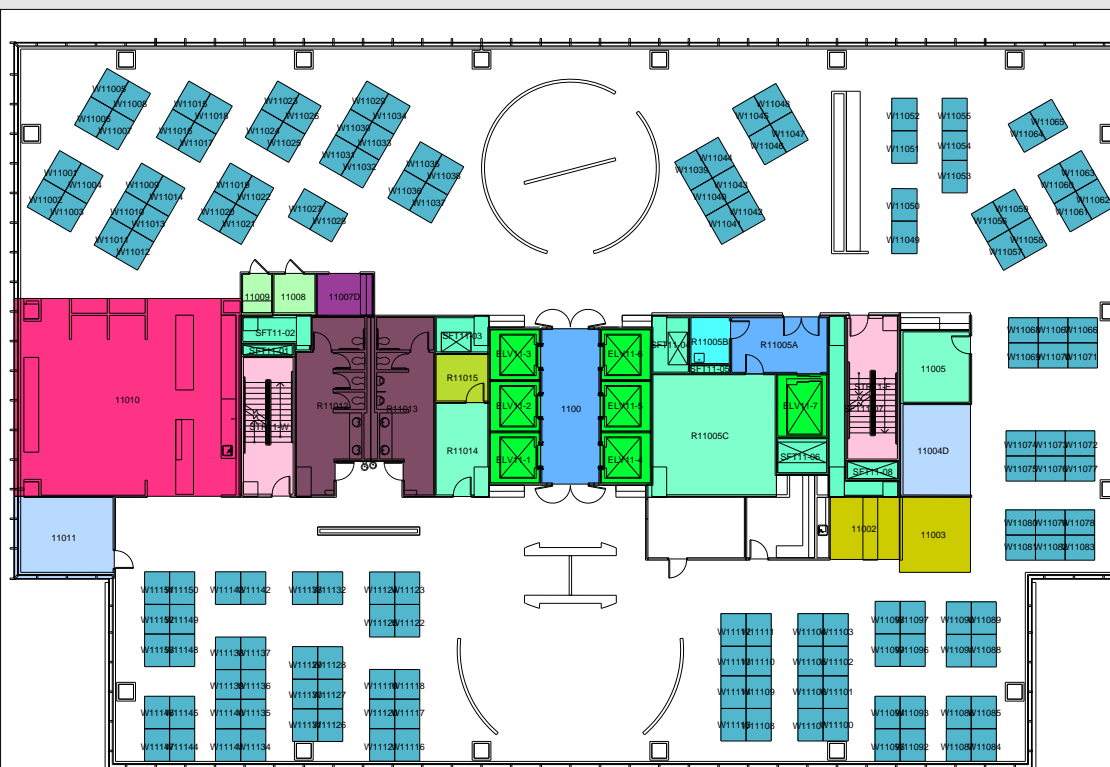

Powered by Archibus

Room Category	Room Type	Legend	Area
PERS	OFFICE		730.22
PERS	WRKS		3,478.57
PROD	HUDDLE		422.08
PROD	PRINT		70.39
SERV	COLLAB		278.08
SERV	EQUIPMENT		56.08
SERV	LOBBY		422.61
SERV	LOUNGE		1,279.27
SERV	RESTROOM		631.97
SERV	TELEPHONE		75.51
STORAGE	CLOSET		90.42
VERT	ELEVATOR		550.67
VERT	SHAFT		409.69
VERT	STAIR		433.68

11th Floor Total:
21,682 RSF
153 Seats

cresa

Cresa © 2019. All rights reserved. The information contained in this document has been obtained from sources believed reliable. While Cresa does not doubt its accuracy, Cresa has not verified it and makes no guarantee, warranty, or representation about it. It is your responsibility to independently confirm its accuracy and completeness. Any projections, opinions, assumptions or estimates used are for example only and do not represent the current or future performance of the property. The value of this transaction to you depends on tax and other factors which should be evaluated by your tax, financial and legal advisors. You and your advisors should conduct a careful, independent investigation of the property to determine to your satisfaction the suitability of the property for your needs.