

# Reduced Rate

## Sublease Promenade II

1230 Peachtree St NE  
Atlanta, GA 30309

[Click to View the Virtual Tour](#)

### Space Profile:

Premises	Suite 1750
RSF	6,658 RSF
Rental Rate	\$20.00 FSG
Availability	Immediate
Term	03/31/2022
Building Class	A
Submarket	Midtown
Built	1991
Parking	1.75/1,000
MARTA	5 Minute Walk to Arts Center Station



**GoSpaces Agreement Offered with the Space**

### Features:

- Elevator lobby entrance
- Furniture negotiable
- Highly upgraded space
- Ability to extend or wrap the term
- Amenities include: Bistro 1230, The Bean Counter & The Commons, Pulse Fitness, Page One News & Sundries, Artist in Residence, Wi-Fi throughout and enhanced outdoor seating, Conference center (seats 75)

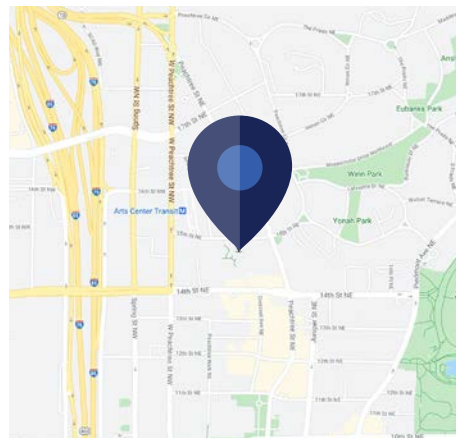

### Contact:



**Kevin Creel**  
404.446.1576  
kcreel@cresa.com



## Promenade II

1230 Peachtree St NE, Atlanta GA

### Contact:



**Kevin Creel**  
404.446.1576  
kcreel@cresa.com



**cresa** . . .

Cresa © 2019. All rights reserved. The information contained in this document has been obtained from sources believed reliable. While Cresa does not doubt its accuracy, Cresa has not verified it and makes no guarantee, warranty, or representation about it. It is your responsibility to independently confirm its accuracy and completeness. Any projections, opinions, assumptions or estimates used are for example only and do not represent the current or future performance of the property. The value of this transaction to you depends on tax and other factors which should be evaluated by your tax, financial and legal advisors. You and your advisors should conduct a careful, independent investigation of the property to determine to your satisfaction the suitability of the property for your needs.



**Promenade II**  
**1230 Peachtree St NE, Atlanta GA**

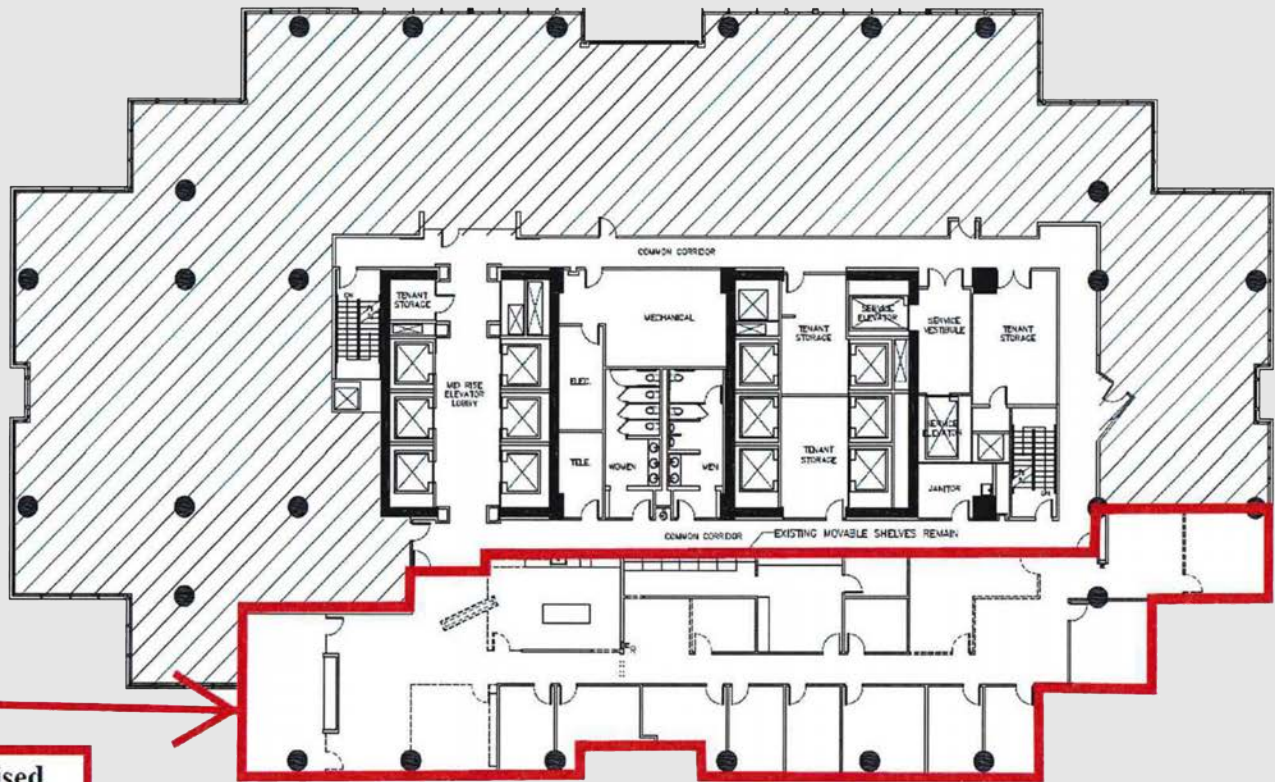

**Demised  
Premises**

SCHEMATIC DEMOLITION  
 FLOOR 17 PLAN  
 16 FEET

- EXISTING PARTITION REMAINS
- - - REMOVE EXISTING PARTITION
- EXISTING DOOR LOCATION REMAINS
- REMOVE EXISTING DOOR FRAME, & HARDWARE



**Kevin Creel**  
 404.446.1576  
 kcreel@cresa.com