

# Tower Place Executive Park

4 Tower Place  
Albany, NY 12203

## Space Profile:

<b>Premises</b>	1st Floor
<b>RSF</b>	2,540 RSF
<b>Rental Rate</b>	\$17.00/SF plus electric
<b>Availability</b>	Immediate
<b>Term</b>	Until 8/31/2025
<b>Building Class</b>	A
<b>Submarket</b>	W Outer Albany County
<b>Parking</b>	4.60/1,000 SF



## Amenities include:

- Brand new fitness facility with locker room and showers in building
- Brand new energy-efficient systems
- Staffed security
- 200 yard walk to [Stuyvesant Plaza's](#) retailers including restaurants, a coffee shop, a bank, a pharmacy, a dry cleaner, a salon, the US Post Office, fitness facilities, and assorted shopping

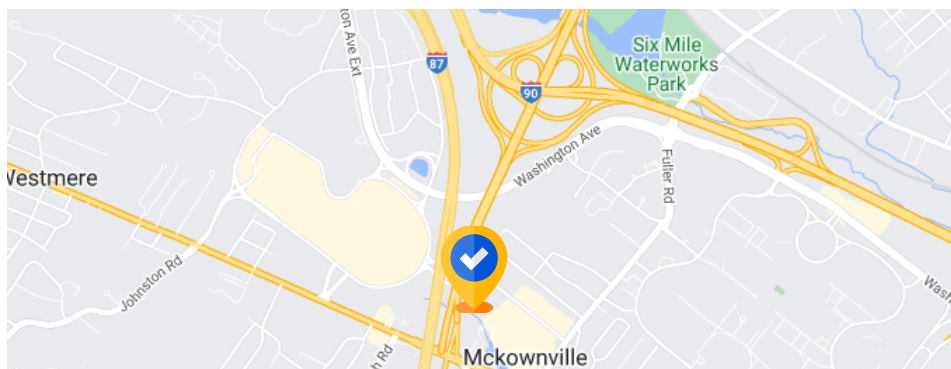

## Contact:



**Zac Conley**  
518.859.2990 mobile  
zconley@cresa.com



**Todd Stevens**  
518.424.7717 mobile  
tstevens@cresa.com





## Tower Place

4 Tower Place, Albany



cresa

Cresa © 2022. All rights reserved. The information contained in this document has been obtained from sources believed reliable. While Cresa does not doubt its accuracy, Cresa has not verified it and makes no guarantee, warranty, or representation about it. It is your responsibility to independently confirm its accuracy and completeness. Any projections, opinions, assumptions or estimates used are for example only and do not represent the current or future performance of the property. The value of this transaction to you depends on tax and other factors which should be evaluated by your tax, financial and legal advisors. You and your advisors should conduct a careful, independent investigation of the property to determine to your satisfaction the suitability of the property for your needs.

# Tower Place

4 Tower Place, Albany

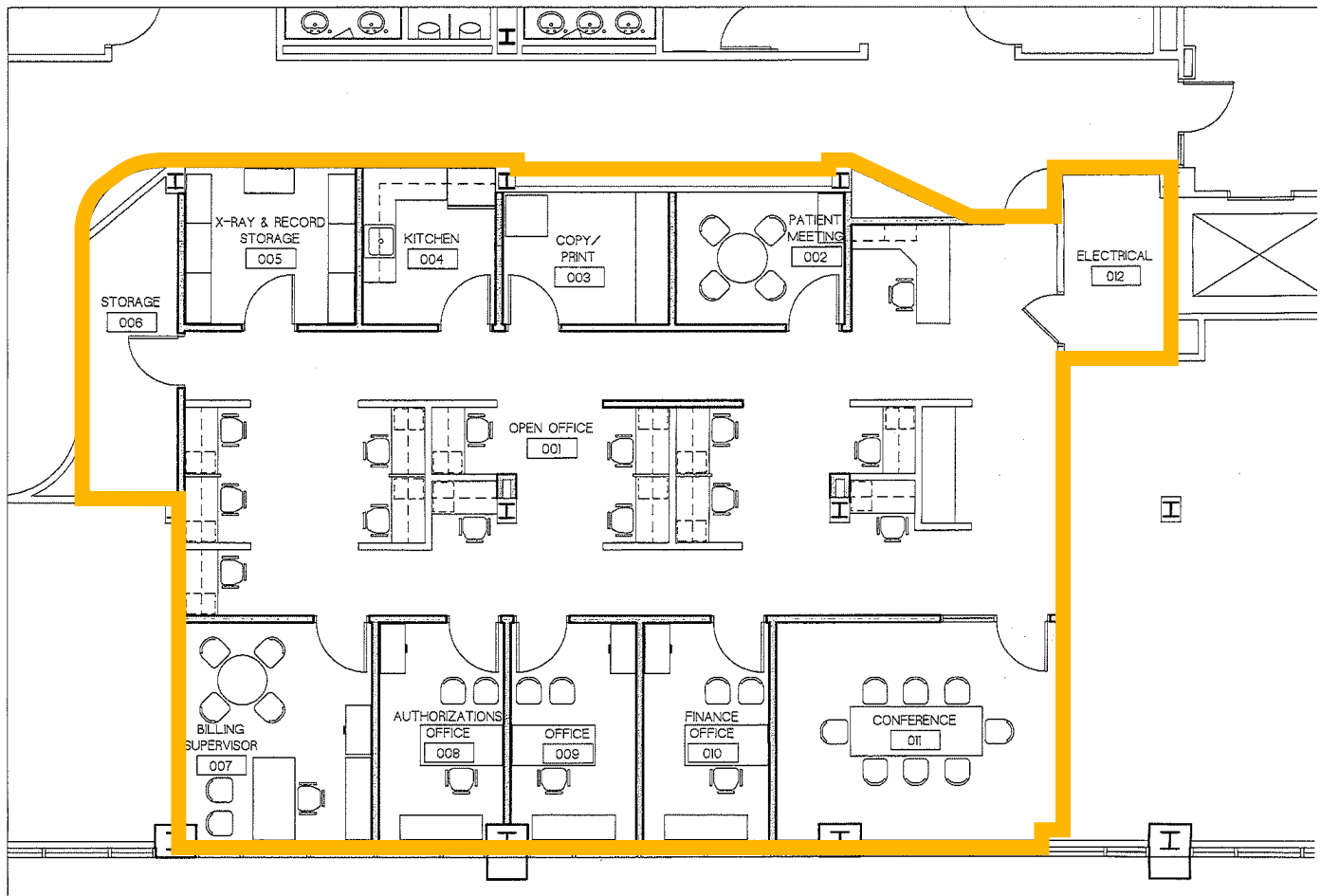

cresa

Cresa © 2022. All rights reserved. The information contained in this document has been obtained from sources believed reliable. While Cresa does not doubt its accuracy, Cresa has not verified it and makes no guarantee, warranty, or representation about it. It is your responsibility to independently confirm its accuracy and completeness. Any projections, opinions, assumptions or estimates used are for example only and do not represent the current or future performance of the property. The value of this transaction to you depends on tax and other factors which should be evaluated by your tax, financial and legal advisors. You and your advisors should conduct a careful, independent investigation of the property to determine to your satisfaction the suitability of the property for your needs.