

Sublease

Center City

433 State Street
Schenectady, NY

Space Profile:

Premises	2nd Floor
RSF	23,225 RSF
Asking Rate	\$15.00/SF Full Service Gross
Availability	Immediate
Term	12/31/2023
Building Class	A
Submarket	Downtown Schenectady
Built	Renovated 2011
Parking	Negotiable

Features:

- Class A office space
- Open floor plan with 8 private offices, 3 conference rooms, large training room, and kitchen
- Located in the heart of Downtown Schenectady

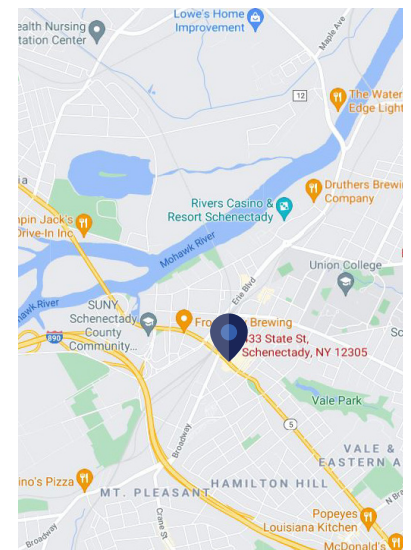

Contact:



Zac Conley
518.859.2990
zconley@cresa.com



Todd Stevens
518.424.7717
tstevens@cresa.com

Floorplan



Second Floor

433 State Street, Schenectady, NY



Floorplan



Third Floor

433 State Street, Schenectady, NY

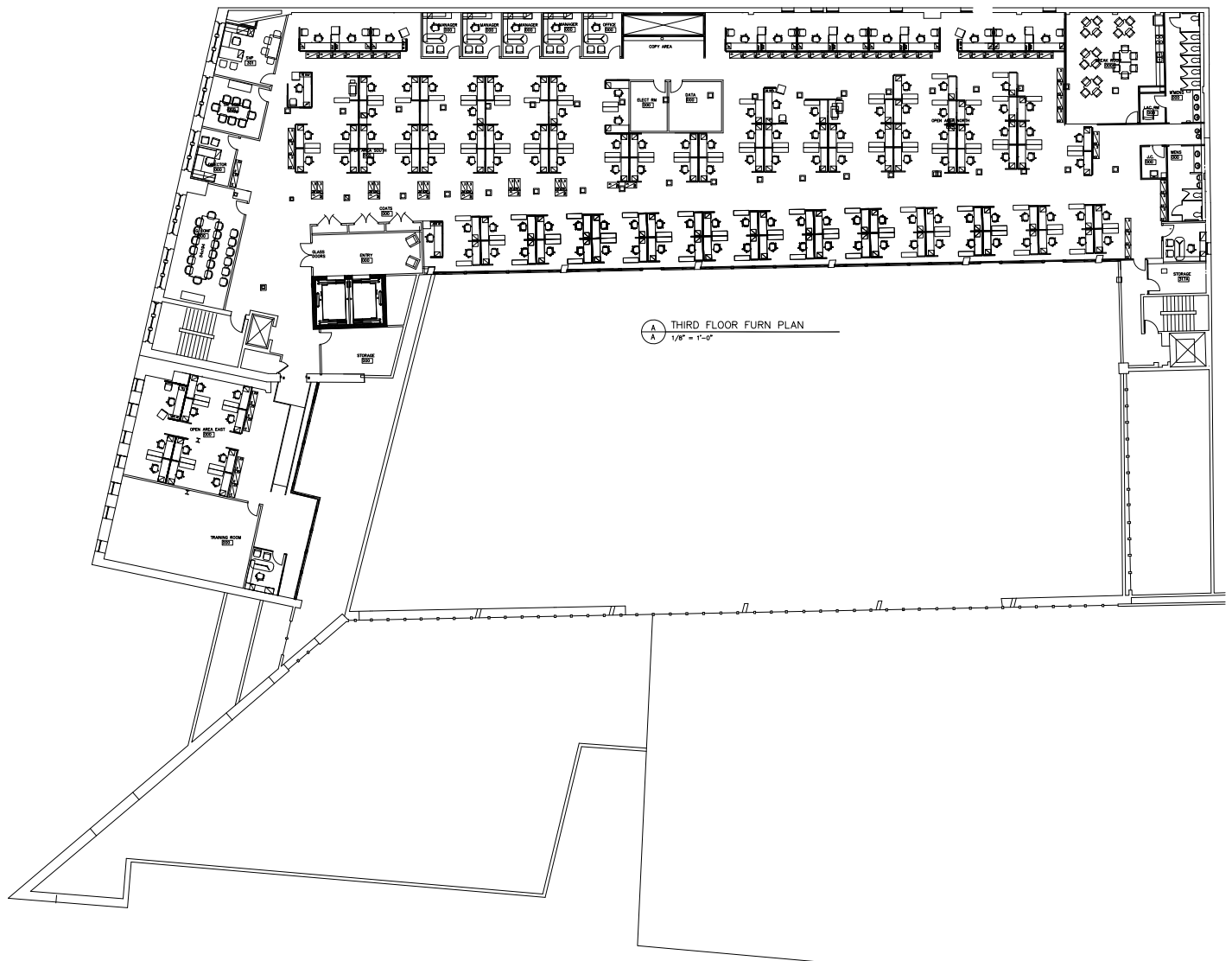



cresa

Cresa © 2021. All rights reserved. The information contained in this document has been obtained from sources believed reliable. While Cresa does not doubt its accuracy, Cresa has not verified it and makes no guarantee, warranty, or representation about it. It is your responsibility to independently confirm its accuracy and completeness. Any projections, opinions, assumptions or estimates used are for example only and do not represent the current or future performance of the property. The value of this transaction to you depends on tax and other factors which should be evaluated by your tax, financial and legal advisors. You and your advisors should conduct a careful, independent investigation of the property to determine to your satisfaction the suitability of the property for your needs.



cresa

Cresa © 2021. All rights reserved. The information contained in this document has been obtained from sources believed reliable. While Cresa does not doubt its accuracy, Cresa has not verified it and makes no guarantee, warranty, or representation about it. It is your responsibility to independently confirm its accuracy and completeness. Any projections, opinions, assumptions or estimates used are for example only and do not represent the current or future performance of the property. The value of this transaction to you depends on tax and other factors which should be evaluated by your tax, financial and legal advisors. You and your advisors should conduct a careful, independent investigation of the property to determine to your satisfaction the suitability of the property for your needs.